

MAKING THINGS HAPPEN



"TRUE STRENGTH LIES IN SUBMISSION WHICH PERMITS ONE TO
DEDICATE HIS LIFE, THROUGH DEVOTION, TO SOMETHING BEYOND
HIMSELF."



FROM THE HEAD ARCHITECT'S DESK



There are 3 categories of people:

1. Who make things happen
2. Who watch things happens
3. Who wondered what happened.

To surge ahead with the towering responsibility of manifesting this wondrous building, warrants the first category.

"If rooted in the true motivation of seva; along with challenges comes the blessings and empowerment to face it." We are very happy to share the various accomplishments during the National Lock down period.

**-VARSHA SHARMA
(VILASINI DD)**

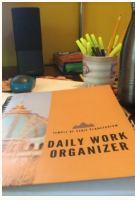

LOCKDOWN 2020



TASKS IN HAND

- Varsha Sharma (Vilasini dd)

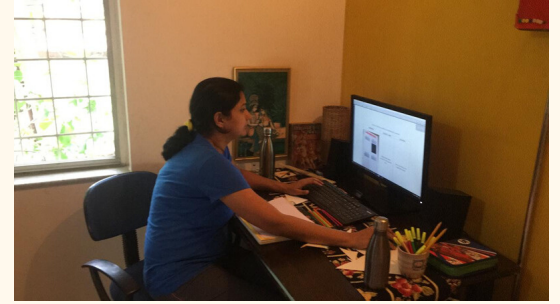

1. DRAWING MANAGEMENT AND CHECKING

- Exterior
- Interiors
- Art work based
- Services

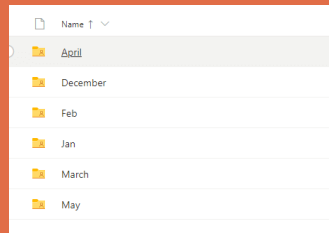

2. DOCUMENTATION AND STORAGE

- Drawings
- Documents
- Visuals
- Site Pictures

Drawings Issued
Landscaping
Lighting Fixture
Measured drawing from Site
Pujari Drawings

3. 3D VISUALS CO-ORDINATION



4. LIGHTING AND ACOUSTICS CO-ORDINATION

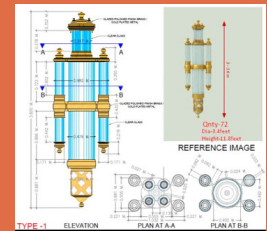

5. GOLD EMBELLISHMENT RESEARCH AND CO-ORDINATION

- Both wings



6. REPORTS AND PRESENTATIONS DIRECTIONS

- Weekly
- Monthly
- Issue based



7. CHANDELIER DISCUSSION WITH VENDORS

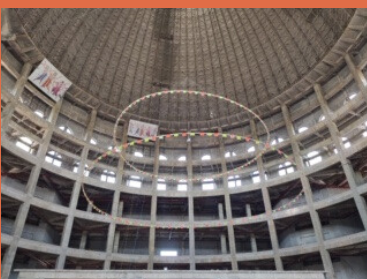

8. COMMUNICATIONS

- Office Team
- Department Team
- Mayapur Team
- Chandelier - Antardwip
- Sadbhuja/Bhavananda Prabhus
- Pankajanghri Prabhu/Jananivas Parbhu
- Consultants





HOW IT ALL STARTED



As the calendar was heading towards the end of March, the government of India announced a nationwide lockdown, that led to a whole new set up of working from home. Whilst which, the team faced some technical issues such as compatibility problems with the heavy files, software license expiration and a major storm that occurred in the state for the first time in almost a century.

But even through all of the challenges faced, the team has been consistently working and achieved multiple milestones. Following through the pages are some highlights.



MODE OF WORK



**TOVP ARCHITECTURE
DEPARTMENT, PUNE**



**TOVP ARCHITECTURE
DEPARTMENT, PUNE**

INTRACOMMUNICATION



ONE DRIVE

INTERCOMMUNICATION



SKYPE

PUNE OFFICE

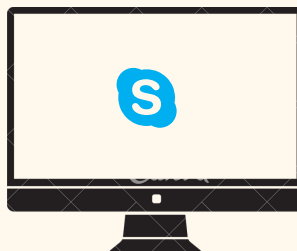

PUNE TEAM

MAYAPUR TEAM



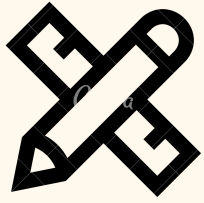

LOCKDOWN 2020



TASKS IN HAND -DESIGN AND DRAWING DEVELOPMENT

ANUJA

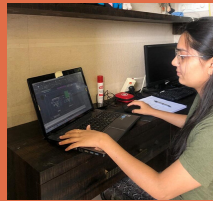

- RCP Intrication for Museum floor-I
- Flooring design-Museum floor -I
- Narsimha wing Podium jaali details
- Side dome tier windows
- Staircase Murals design

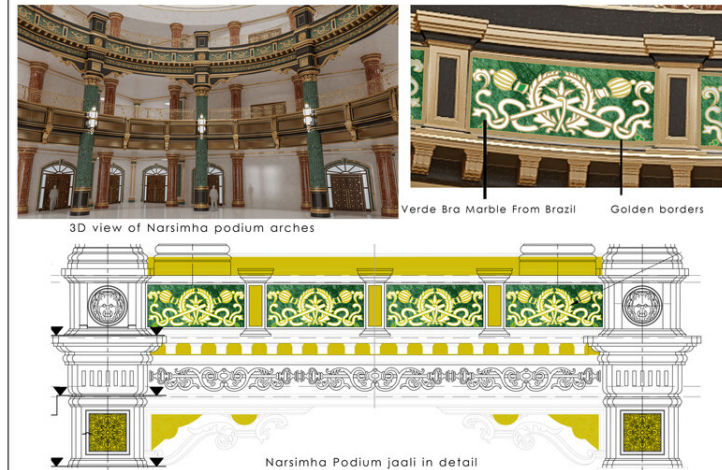

SANDARBH



- Narsimha dev wing Columns
- S.P Vyasasna Columns detailing
- Wall columns detailing
- Elephant column base design
- Yajna shelter roof details

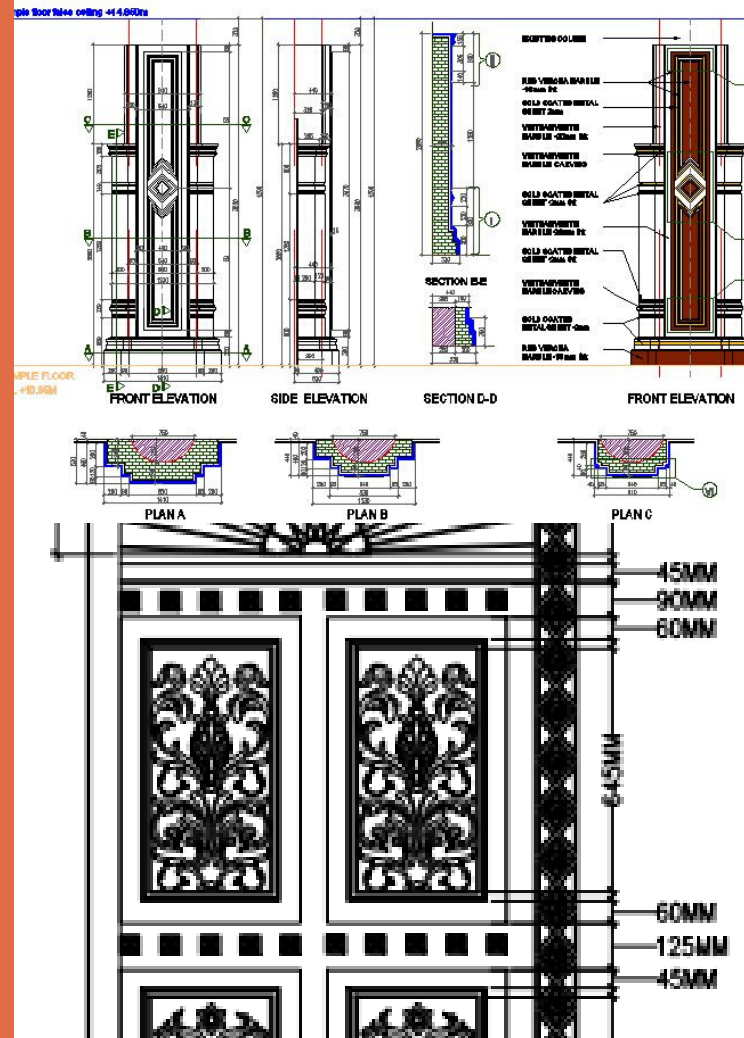

HRISHIKESH



- Final Door window Schedule
- Grand Staircase detailing
- Isckon Yantra to design
- Staircase Murals design
- S.P Bridge detailing

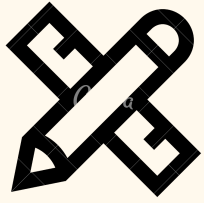

LOCKDOWN 2020



TASKS IN HAND

- Research and Checking

ANUPAMA



- Power Socket
- Review the Temple floor
- lighting layout
- Utility Floor Services Requirement
- Check Lux Report
- Museum III RCP needs to be sent

DEVENDRA



- Altar doors, teak & Mother of pearl doors Vendor
- Stained Glass Vendor
- Lakha Red Sample
- Carbon fibre-Material

RELEASED FOR
EXECUTION





LOCKDOWN 2020



TASKS IN HAND -Communication

DIPTI



- Update deliverable chart & Architect task list
- Follow up with all In house architect & co
- Coordinating for all files & folder search
- Sending Drawing & update tracker
- Rearranging Open tracker, Architect task list
- Expense Chart

AISHWARYA



- Reports
- Social Media handling
- Charts and Posters
- Quantities

Temple of the Vedic Planetarium, Mayapur, West Bengal			Temple of the Vedic Planetarium, Mayapur, West Bengal		
Compendium of Architectural Drawings - Modules of Interior Works			Compendium of Architectural Drawings - Modules of Interior Works		
MAIN WING & NARSHIMHA INTERIOR - TEMPLE FLOOR			MAIN WING & NARSHIMHA INTERIOR - TEMPLE FLOOR		
DATE: 12.05.2020			DATE: 12.05.2020		
MODULE	TOVP DRAWING STATUS	CONST STATUS	Veneklassen Associates	Lighting Consultant	
MAIN WING-PODIUM FAÇADE (JALI ARCH)			MAIN WING-PODIUM FAÇADE (JALI ARCH)		
I ventilation jali arch		Not yet started			
II ventilation jali arch					
III ventilation jali arch					
Door ventilation Shaft area					
IV Jali Arch					
NARSHIMHA WING-PODIUM FAÇADE (JALI ARCH)			NARSHIMHA WING-PODIUM FAÇADE (JALI ARCH)		
I		Not yet started			
II					
III					
Door					
IV Level					
MAIN WING (PEACOCK RAILINGS)			MAIN WING (PEACOCK RAILINGS)		
I		Not yet started			
II					
III					
Door					
IV Level					
NARSHIMHA DEV WING (RAILINGS)			NARSHIMHA DEV WING (RAILINGS)		
I		Not yet started			
II					
III					
Door					
IV Level					



Minimalist Modelling Portfolio Presenta... Green and Pink Scien... Orange and White

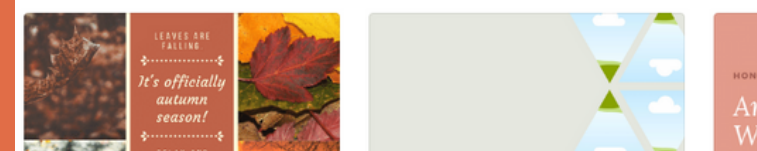



LOCKDOWN 2020



TASKS IN HAND In Mayapur

RANGAVATI

- Narsimha Shringasana
- Main altar & Vyasasana Ceiling Plan
- Main ,Narsimha Altar Vyasasana Lighting Drawing
- Narsimha temple Gallery

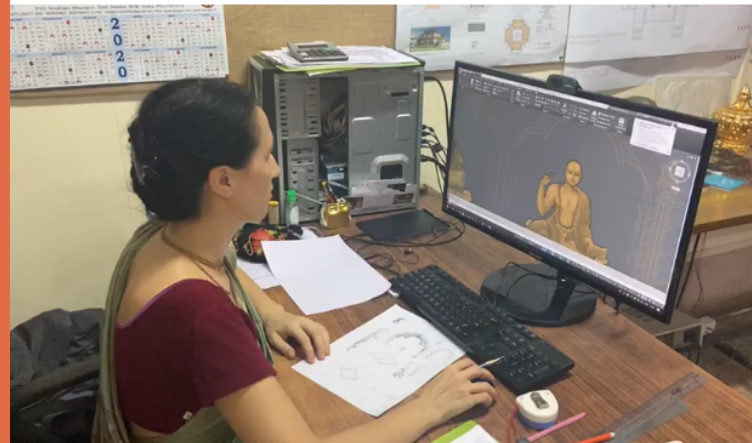

PAVANA GOPA

- 3D Modelling NRS Deity

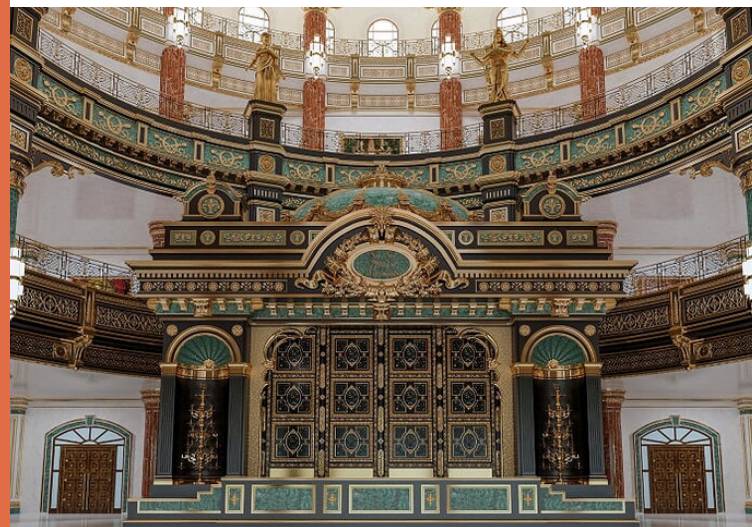



TARGETS ACHIEVED

"Optimism is the faith that leads to achievement. Nothing can be done without hope and confidence."

MAIN PODIUM COLUMN

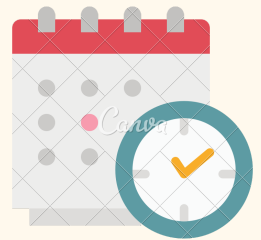

Released on
May 11th 2020

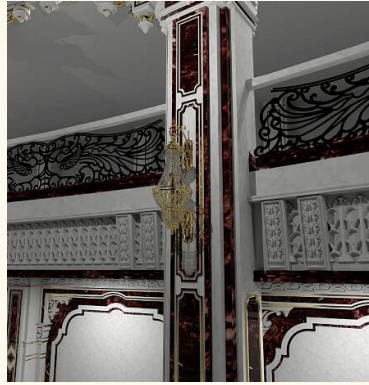

1. Main Podium Column

2. In between Main Podium & Expansion Joint

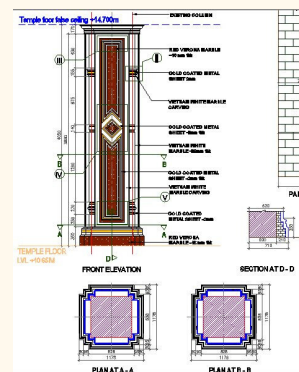
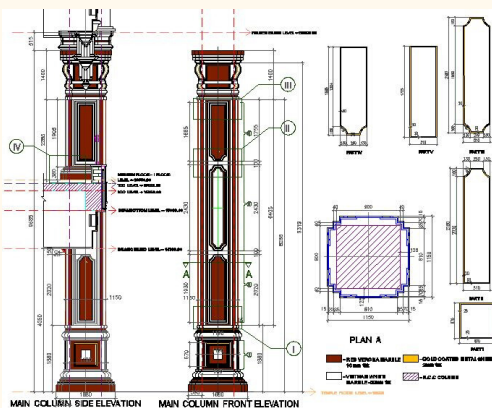

3. Expansion Joint

4. Festival Altar wall Column

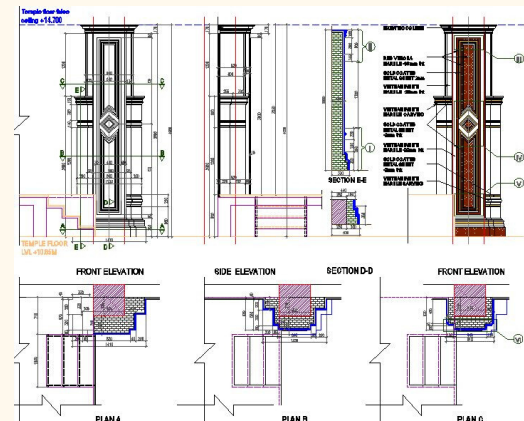
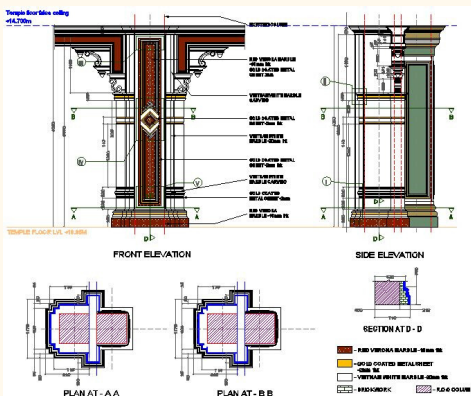

5. Rear wall Column, front Veranda wall inner half column

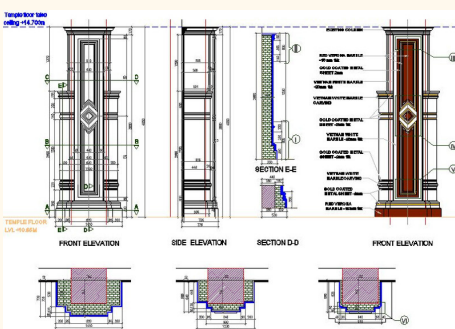

MAIN WING - PODIUM FAÇADE (JALI ARCH)

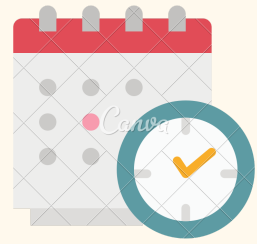

Released on
May 24th 2020

1. Museum-I ventilation jali arch

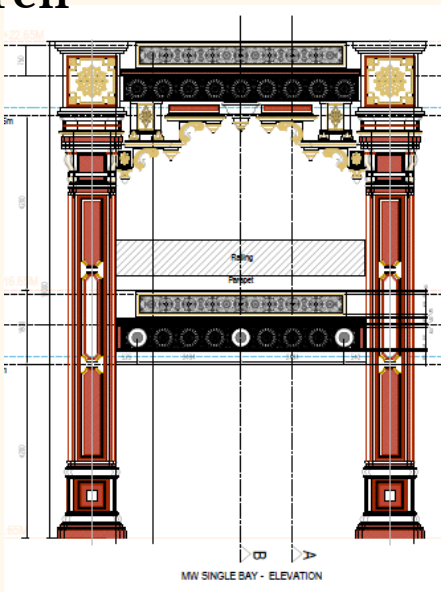

2. Museum-II ventilation jali arch

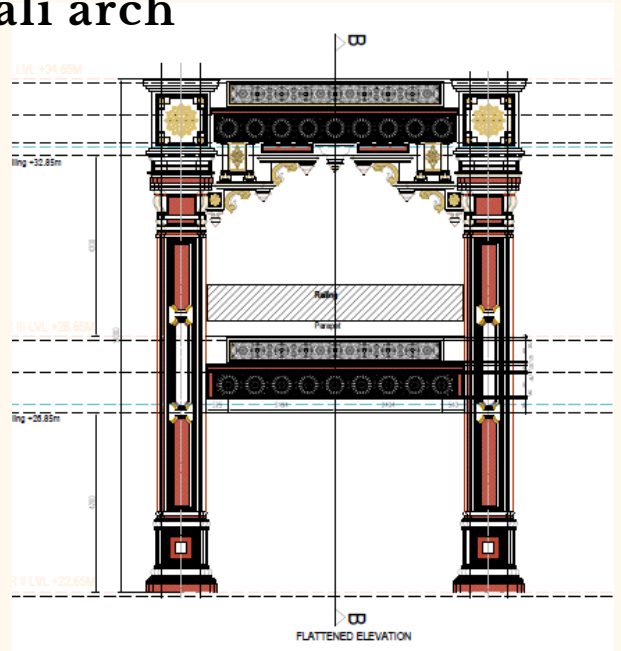

3. Museum-III ventilation jali arch

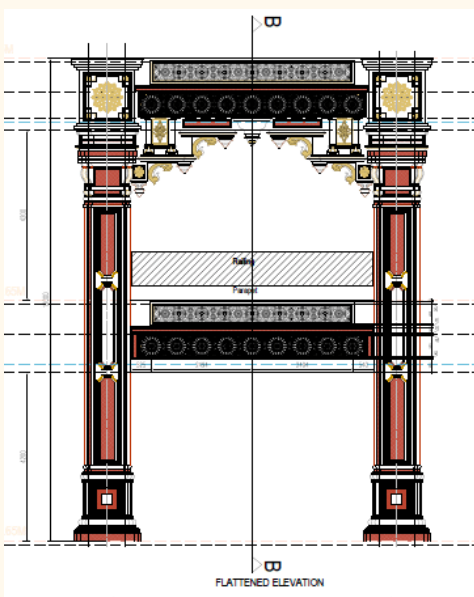

4. Dome Tier Jali Arch

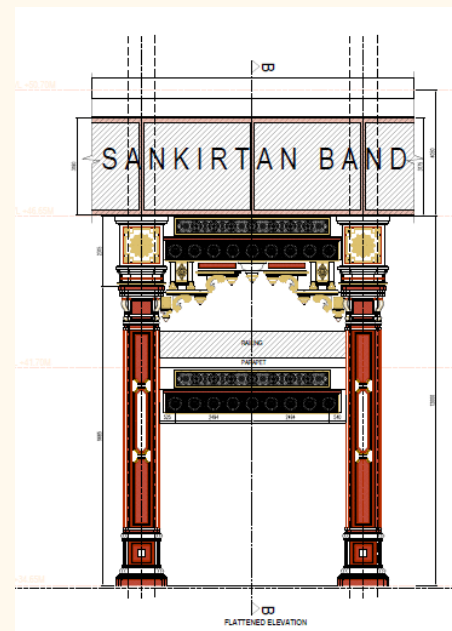

OTHERS

1.SP Interior and Altar Design



2. Main Interior and Altar Design



3. Narsimhadev wing-new design



4. Temple floor RCP

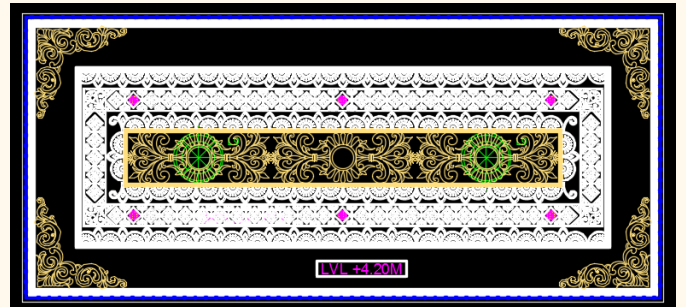

5. Railings

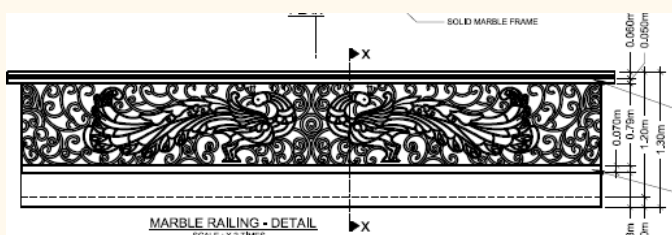

6. Sankirtan Band Revised Angular Details

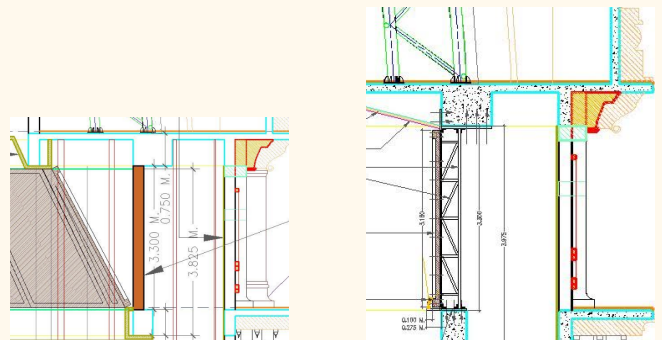

TARGETS AND TRACKING

Temple of the Vedic Planetarium,Mayapur,West Bengal						
DESIGN + 3D DELIVERABLES						
DATE:08.05.2020						
SL.NO	ITEMS	DESIGN	3D	DELIVERABLE DATE	AWAITED BY	COMMENTS BY RANGVATI
1	Vyasasana Ceiling Plan	Rangavati			C&W E-Sollutions	Or after Narasimha Sringasana
2	Main ,Narsimha Altar Vyasasana Lighting Dwg	Rangavati & Radhavallabha			Lighting consultant	On hold Radhavallabh Prabhu not available
	Main temple gallery				Lighting & Acoustic	

1. DESIGN AND 3D DELIVERABLES

Temple of the Vedic Planetarium,Mayapur,West Bengal				2 SANDARBH			
ARCHITECT TASK LIST				SL	DRAWING NAME	STATUS	DATE
DATE:18.05.2020							
SL	DRAWING NAME	STATUS	DATE				
1	MV Jali & diffuser location	Completed	05.05.2020P	1	Main wing columns	Completed	06.5.2020P
2	RCP Intrication for above temple floor floor	Ongoing Museum I by 22nd May		2	Narsimha dev wing Columns	Ongoing	
3	Museum II & III	After Museum I		3	Sankirtan band	Swaha Matsji dependency	
4	Narsimha wing Podium jali details	Just		4	Wall column detailing	Waiting for Rangavati drawing to check.	
5	Main wing detail refinement	Arch's started few drawing remaining (On hold)		5	Tier I,Side dome Tier II (Main wing)	Drawings are ready need to send for checking	
6	Escalator steps	Need basic drawing from Anapama (On hold)		6	Elephant column base design	Edits in design not yet started	
7	Side dome tier windows	Main dome window completed & rest for		7	Yajna shelter roof details	Not yet started	
8	Garuda Jali design	Not yet started		8			
9	Narsimha wing Gold embellishment	Co ordinating with Aishwarya		9			
10	Museum floor II,III & above flooring	Not yet started		10			
11				11			
12				12			
13				13			
14				14			
15				15			

2. ARCHITECTURAL WORKS AND TRACK RECORD

Temple of the Vedic Planetarium,Mayapur,West Bengal				
ARCHITECTURAL DRAWING LIST FOR CW				
18.05.2020				
SL.NO	LOCATION	TASK	DRAWING DESCRIPTION	STATUS
1-Reflected Ceiling Plan				
1.1	Temple floor	RCP Drawing	RCP Drawing for Temple Floor	Drawing will be released on May 30th 2020
1.2	Museum floor 1	RCP Drawing	RCP Drawing for Museum Floors 1	MEP Consultant for co ordinated layout
1.3	Museum floor 2	RCP Drawing	RCP Drawing for Museum Floors 2	Ministry of lights followed by MEP Consultant for co ordinated layout
1.4	Museum floor 3	RCP Drawing	RCP Drawing for Museum Floors 3	Ministry of lights followed by MEP Consultant for co ordinated layout

3. CO-ORDINATION WITH CUSHMAN AND WAKEFEILD

Temple of the Vedic Planetarium,Mayapur,West Bengal				Temple of the Vedic Planetarium,Mayapur,West Bengal		
Compendium of Architectural Drawings - Modules of Interior Works				Compendium of Architectural Drawings - Modules of Interior Works		
MAIN WING & NARSHIMHA INTERIOR -TEMPLE FLOOR				MAIN WING & NARSHIMHA INTERIOR -TEMPLE FLOOR		
DATE:12.05.2020				DATE:12.05.2020		
DRAWING NO	MODULE	TOVP DRAWING STATUS	CONST STATUS	CONSULTANTS		
				Veneklasen Associates	Lighting Consultant	Acoustics
1	1	MW & NW-TF(CEILING)				
	M,N-1.1	Temple floor				
	M,N-1.2	Museum floor I				
	M,N-1.3	Museum floor II				
	M,N-1.4	Museum floor III				
	M,N-1.5	Service floor				
	M,N-1.6	Tier Floor				
2	2	MW & NW TF (FLOORING)				

4. OVERALL ARCHITECTURAL AND CONSTRUCTION WORKS

CURRENTLY ON SITE

ALTAR DISCUSSION
WITH JANANIVAS
PRABHU



PAINTING
DEMIGODS



CHANDELIER
MODEL-MAIN WING

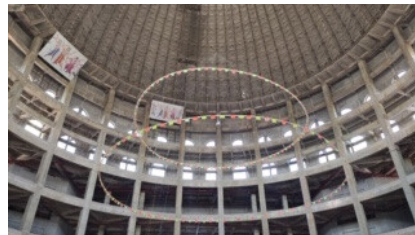

3D WORKS

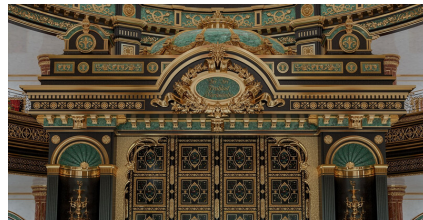

NARSIMHADEV
CHANDELIER



GURU PARAMPARA
CASTING



ARTWORK,
MOSAICS, PAINTINGS

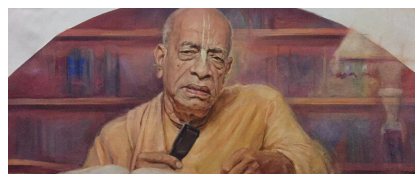



IN CONCLUSION

***“WHEN PEOPLE ARE SITTING
AT HOME, THEY START
THINKING AND INNOVATING”***

Once the storm is over, you won't remember how you made it through, how you managed to survive. You won't even be sure whether the storm is really over. But one thing is certain. When you come out of the storm, you won't be the same person who walked in.”

—Haruki Murakami, Kafka on the Shore

The lockdown may have made us retreat into a bubble, but it is a digitised bubble—from virtual parties to conference calls, webinars to online learning courses. With that said, we as a crowd have been very optimistic about the situation. That is the best way to move forward, than to get bogged down by fear or uncertainty.

But amidst all of the all the fires, the pandemic and the cyclone, we have gotten through the first six months of the year. And within the blink of an eye, it will be the year of 2022, where we will be celebrating "TOGETHER" the Grand Opening of The ToVP!!

