



**TOVP ARCHITECTURE DEPARTMENT
OCTOBER 2020**

**DETAILS IN A
HUNDRED PLACES**

REFLECTED CEILING PLANS

FROM THE HEAD ARCHITECT'S DESK

**AR.VARSHA SHARMA
(VILASINI DD)**



The responsibility of the architecture lies to facilitate the socio-spiritual process that is embedded in the cultural practice of the Vaisnava philosophy.

As the user enters the enormous volume housed by the dome, the vision of the user circumambulates the round rim of the dome and all it's levels below, thus resting on the ceiling – creating an awe inspiring reverence in the heart of the user.

The ceiling with it's superabundance of décor and motifs of nature repeated in progressive arrangements drops down to punctuate into columns towards the floor... and various corners within the temple have their own identities, all bound together by it's sky housed by the ceiling.

Ceiling – heavens – sky – the crucial roof is now underway. Please read on for details.

Reflected Ceiling Plans

The reflected ceiling plans are very ornate and intricate works that involve multiple interdependences. It is a process that involves layers of changes on various fronts. All the services that are involved in designing the temple floor are camouflaged into this ceiling. Hence the appearance of even the smallest of a light fitting is selected with extreme curation from the vendors in order to match the design.

ARCHITECTURAL PLAN - MAIN WING AND NARSIMHADEV WING

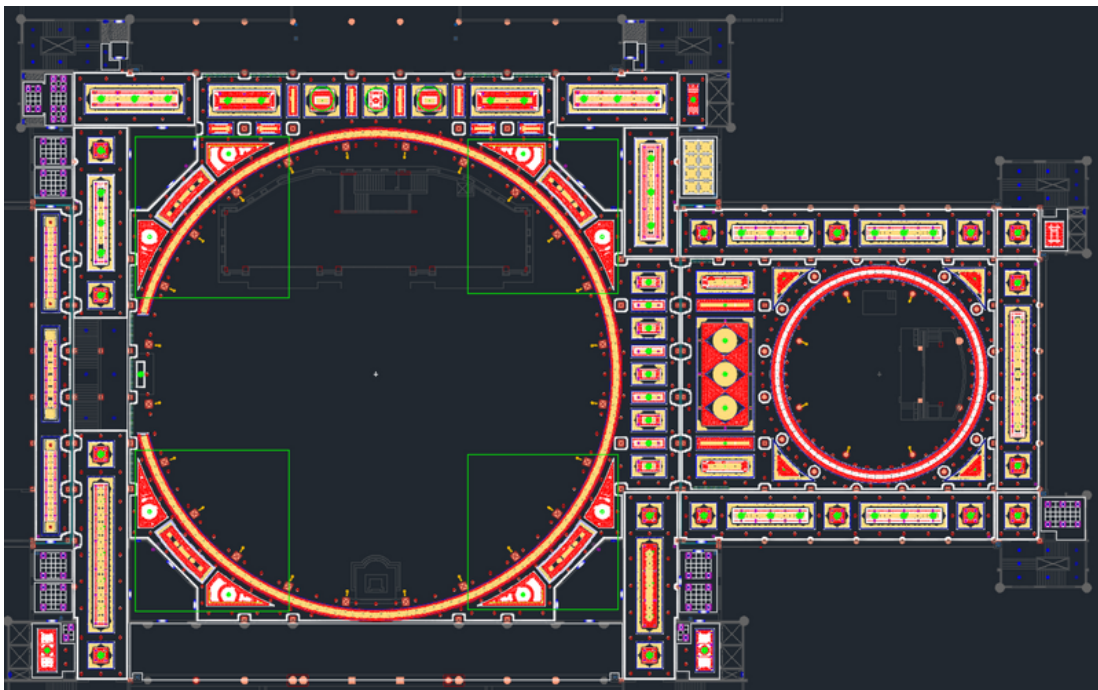

ZONE WISE DISTRIBUTION PLAN

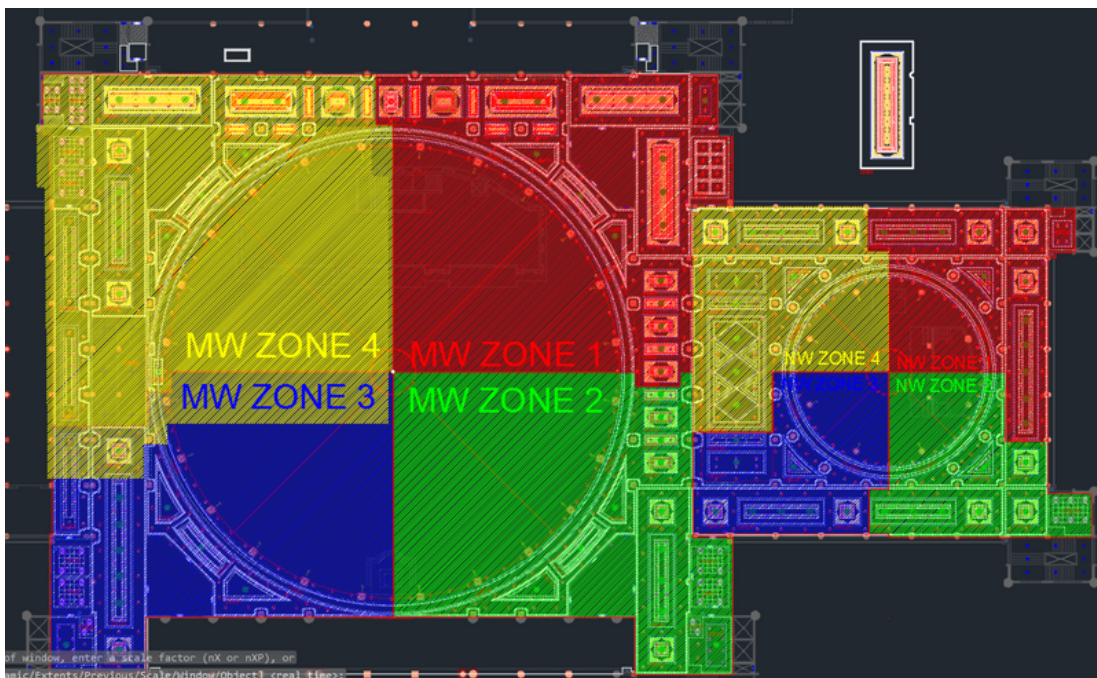



SERVICES

The crux of all the RCP designs and planning lies in blending the legions of services that go past the ceiling. The design that is now finalized is a delicate and careful blend of both. These serve as a working framework throughout the actual construction process..

The final outcome is a journey of series of schematic designs, administrations, planning and overlaying of designs.

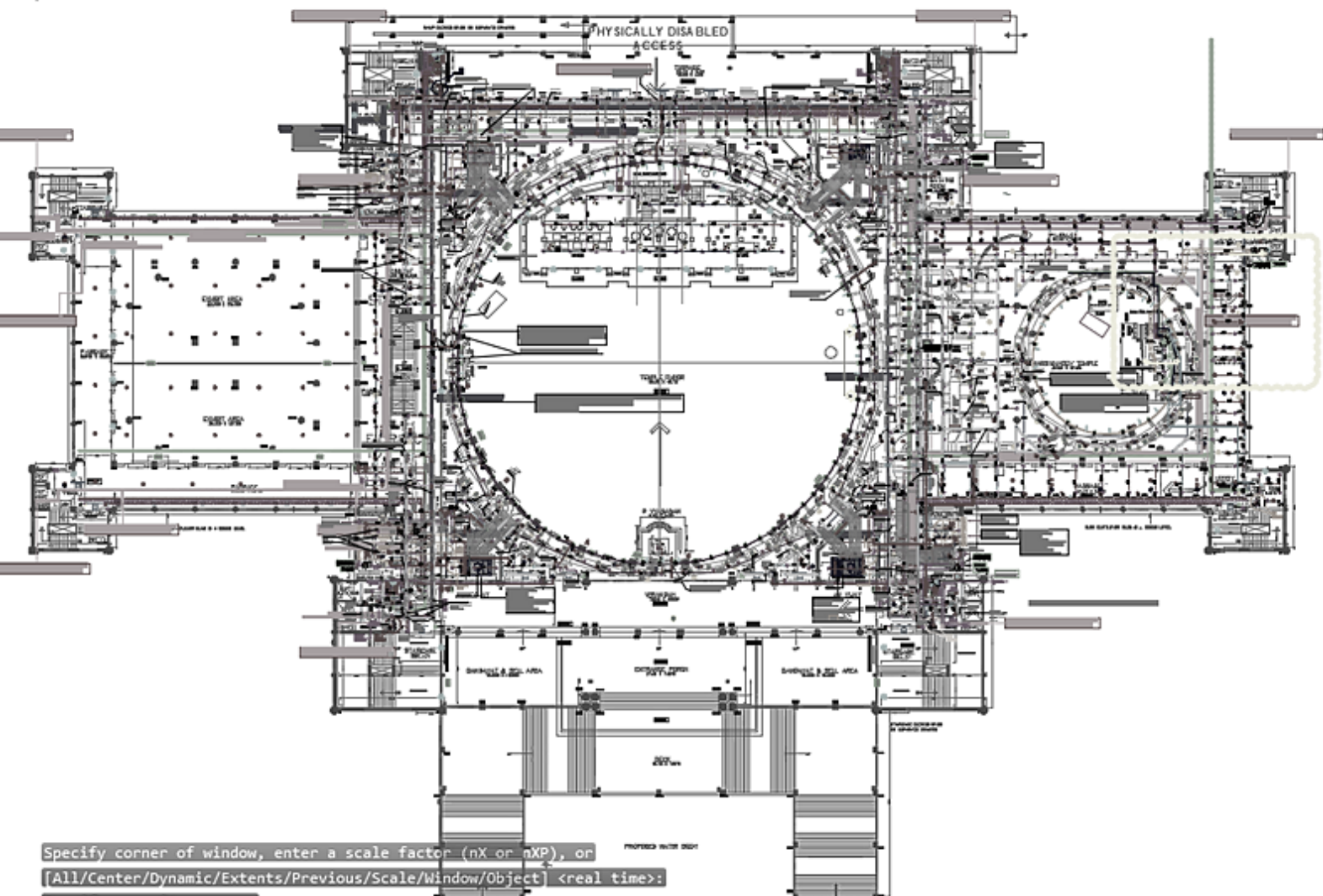

Layers of Design, Services, Design

Architectural and Civil construction give shape, structure and aesthetics to a building but MEP or Mechanical, Electrical and Plumbing bring facilities for life providing services. Hence a detailed organization of these Building Services is essential.

1 RCP PANEL TYPE

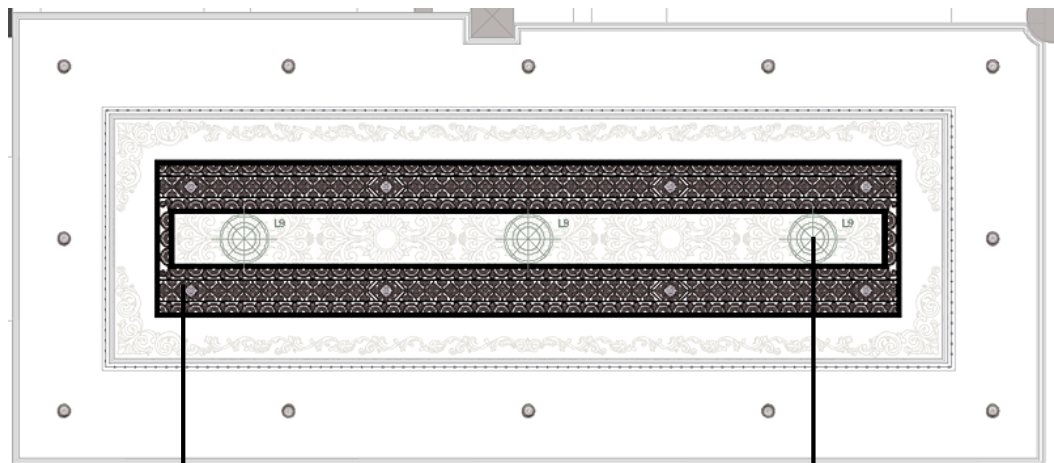

2 LIGHT FIXTURE PERFORATION

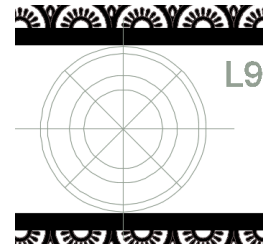

3 GRG ORNAMENTAION AROUND PERFORATION

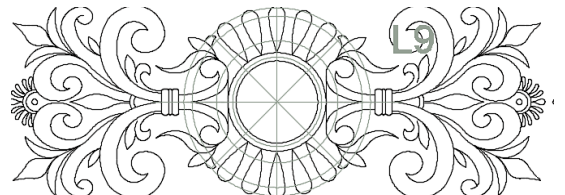

Hierarchy of Services

The items that go inside the ceiling.

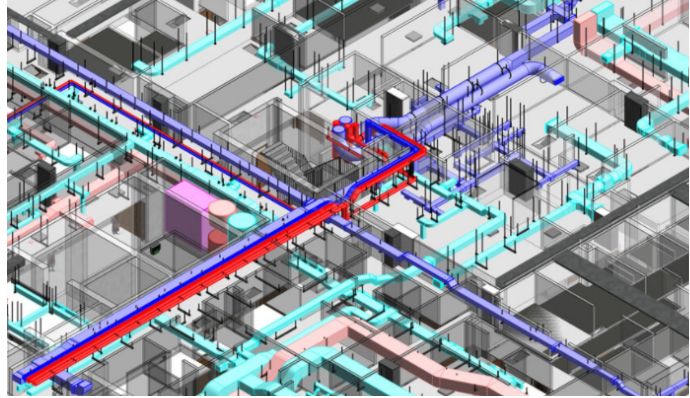

Sprinkler Heads



Smoke detector



Response Indicator



PA speakers



CCTV



Circular diffuser



Linear grill



Jet nozzle



AV Speaker



WIFI AP



Light fixture



LMS sensor

Application Details

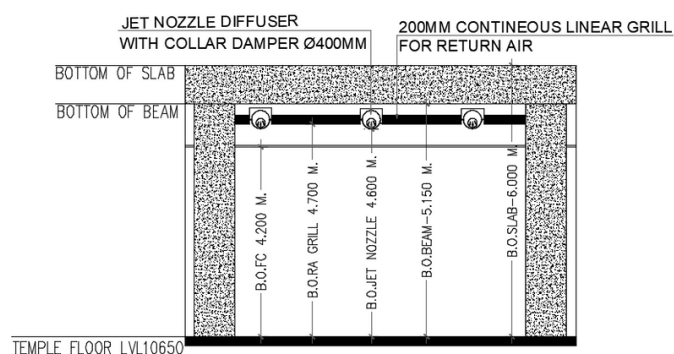
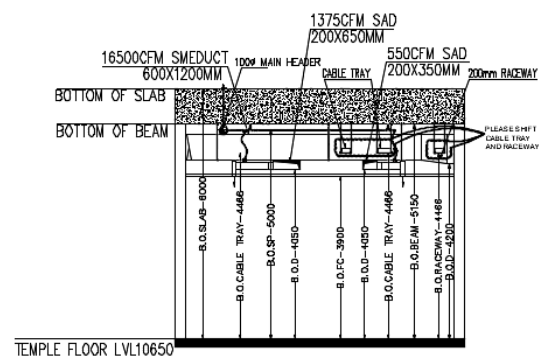
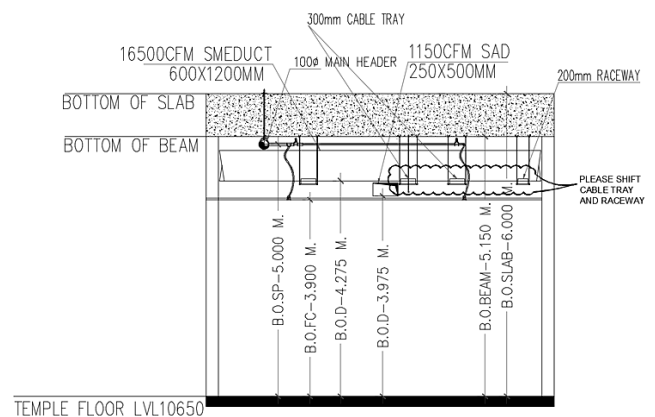

Materials (Straight Panels)

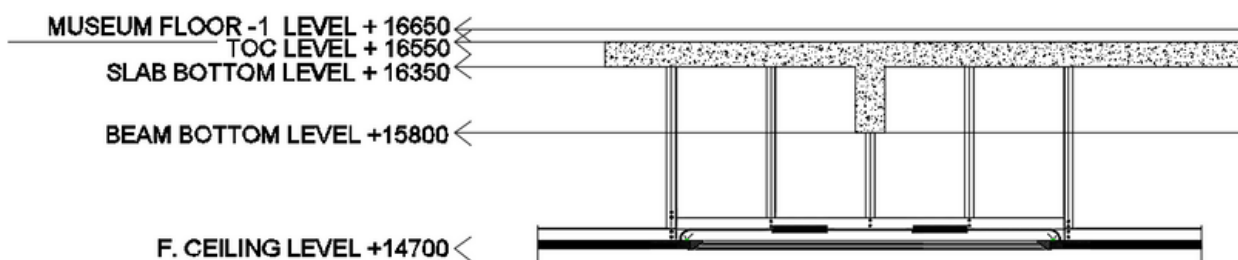

Typical Section

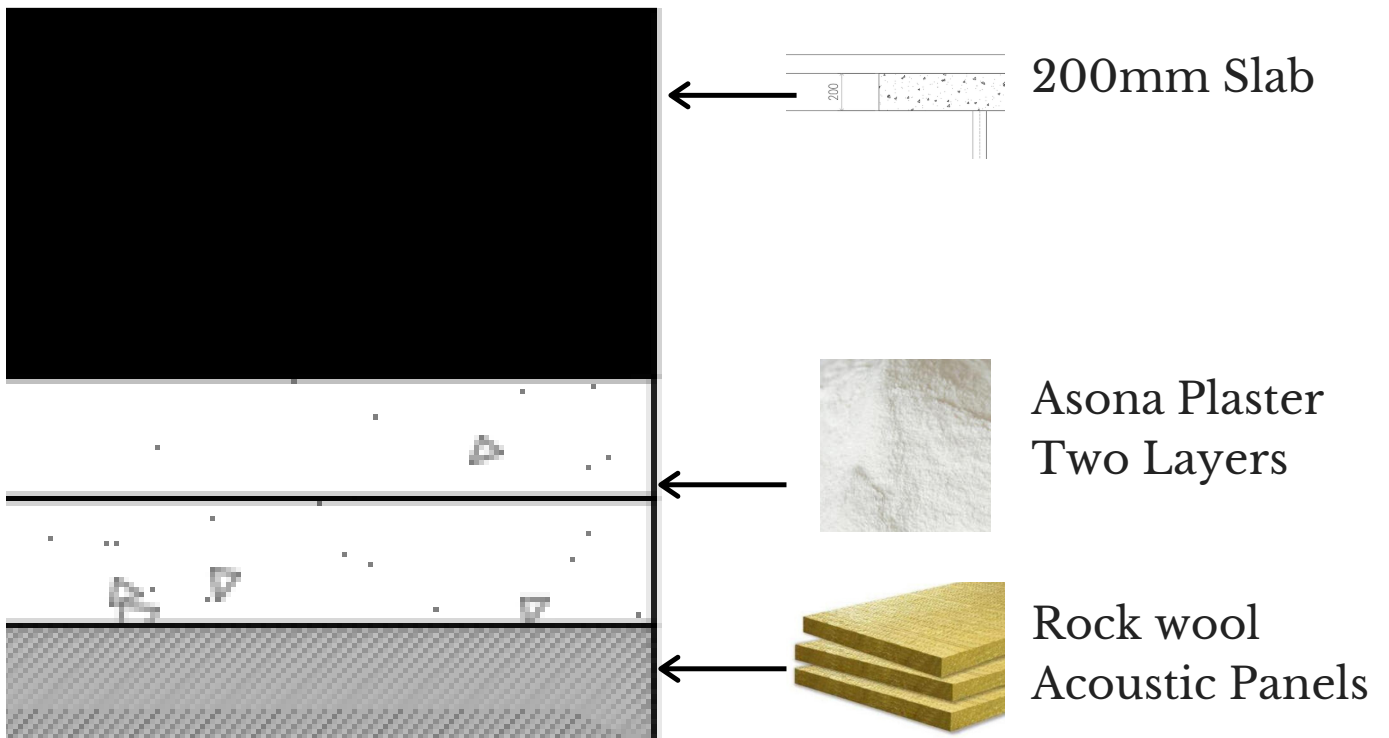

Material Details

Materials (Mouldings)

Produced in the in house
GRG Factory

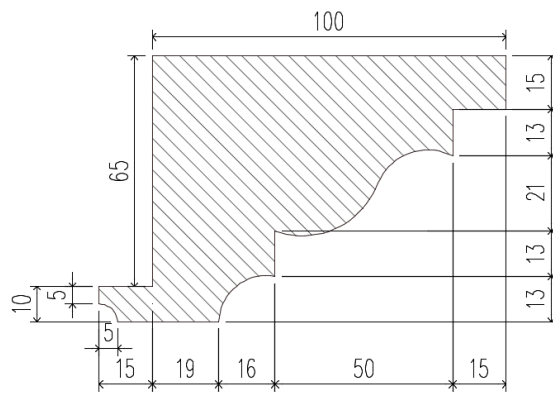
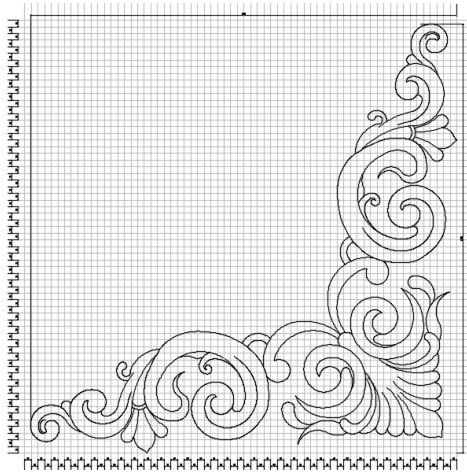

Moulding Details

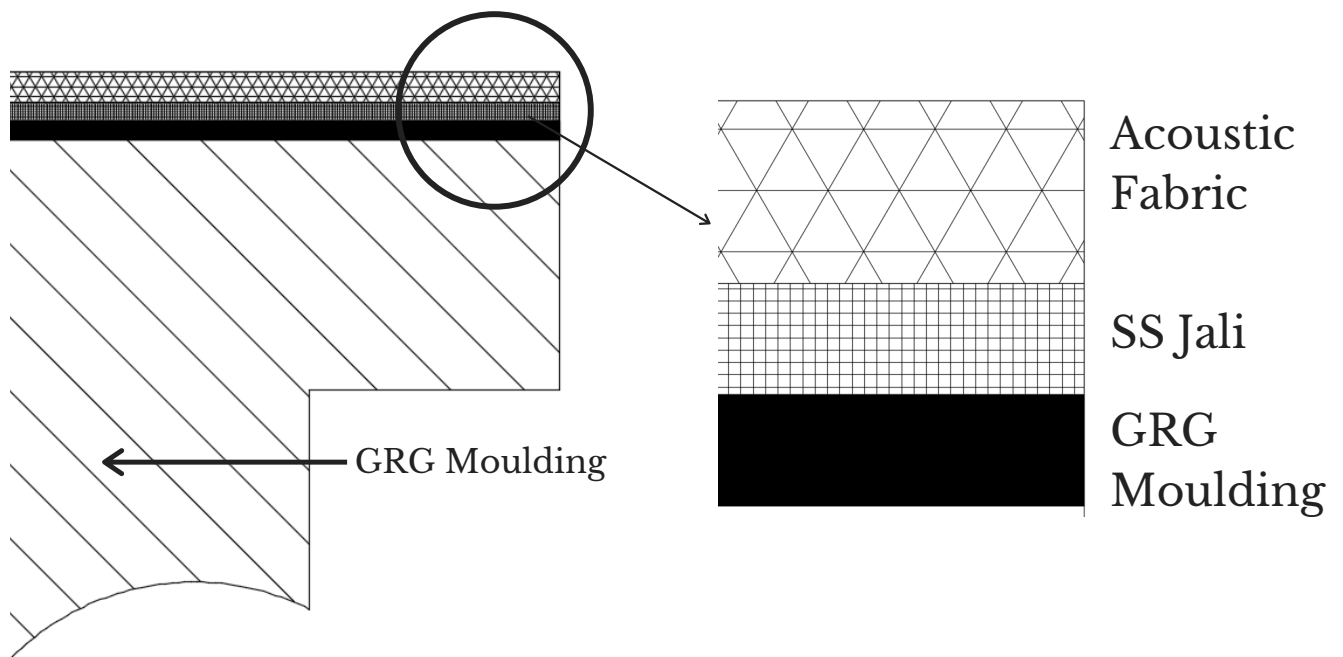

Material Details

Typical Design Modules

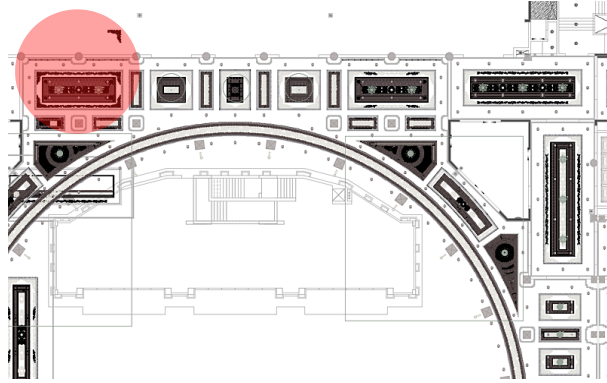

PANEL DESIGN

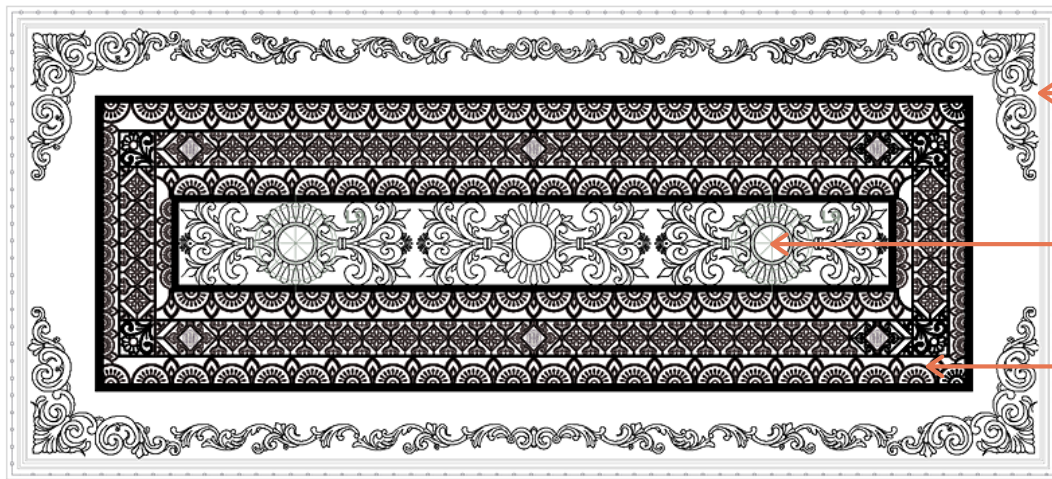

GRG Cornices

Light Fixtures

SS Panels with
Asona Plaster

INTRICACIONS

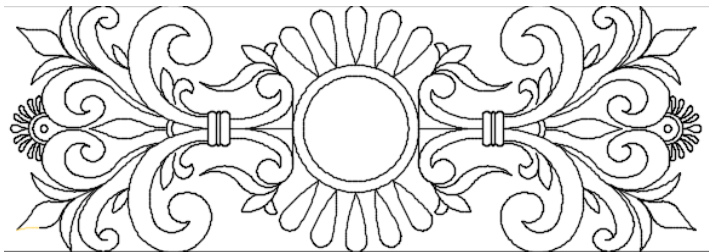

Typical Design Modules

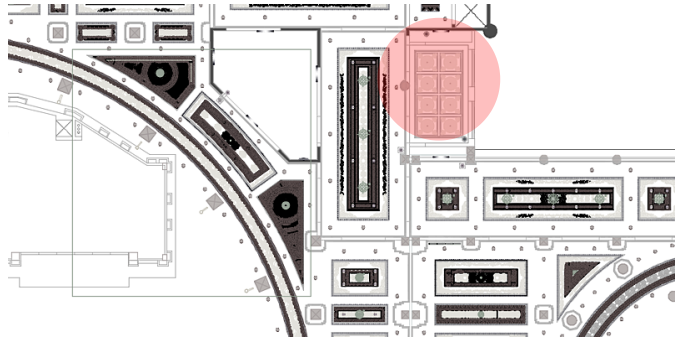

PANEL DESIGN

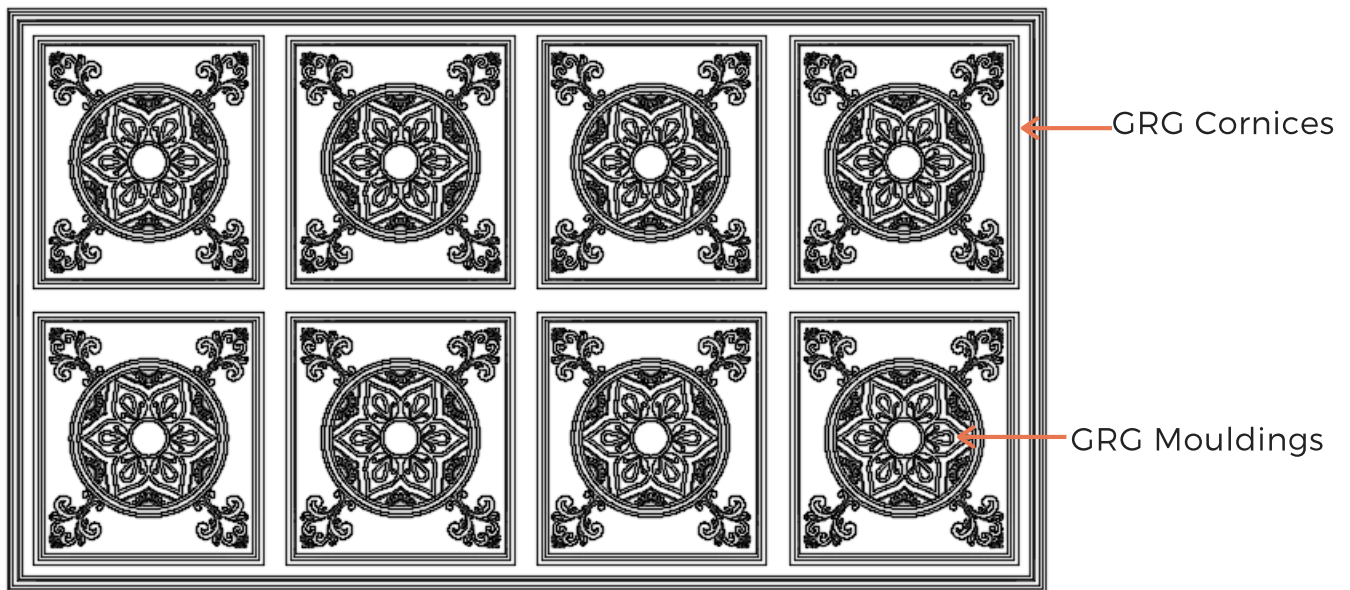

INTRICACIONS

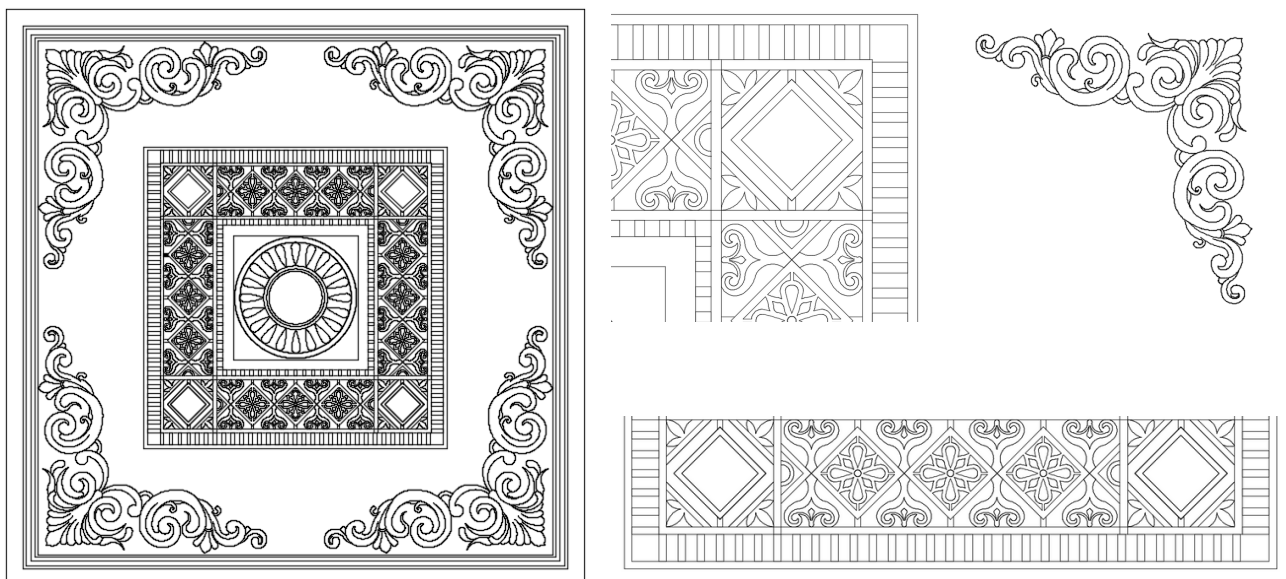

Typical Design Modules

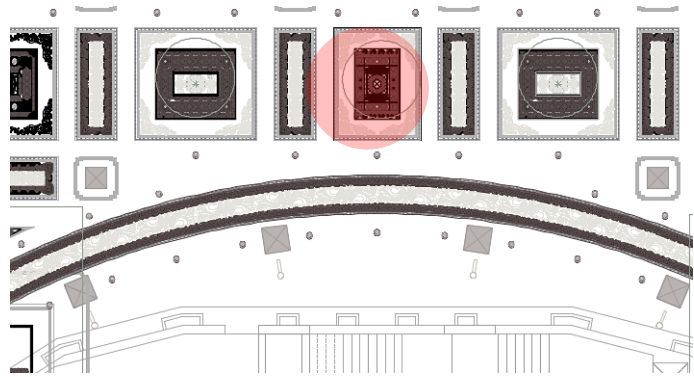

PANEL DESIGN

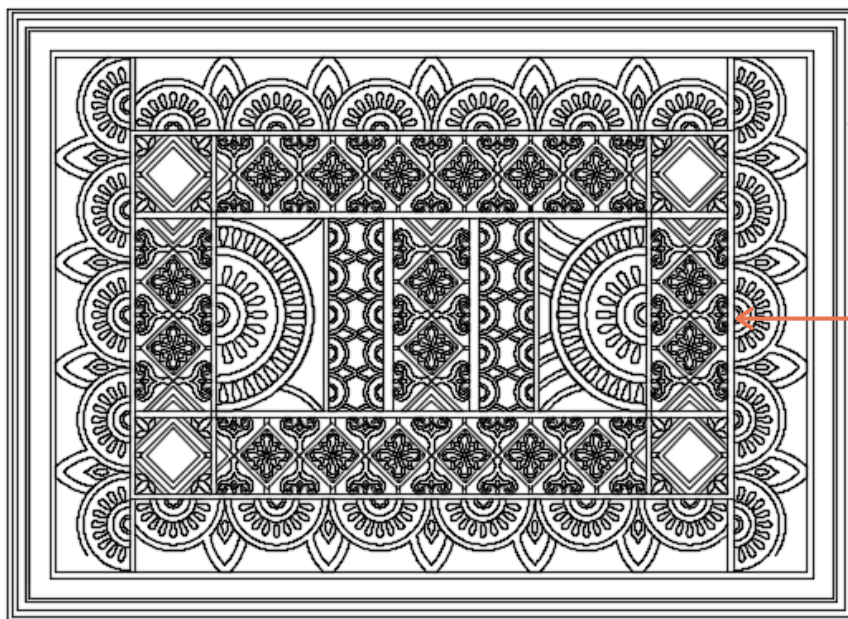

← GRG Cornices

← S S Jalis

INTRICATIONS

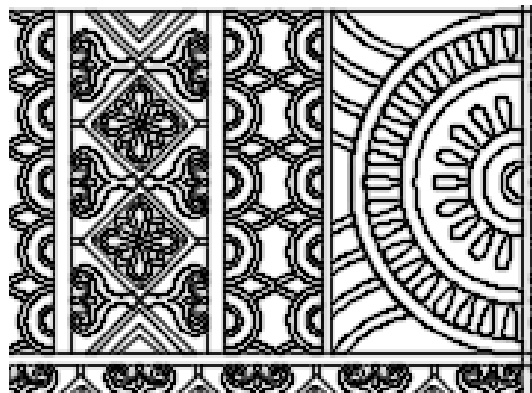
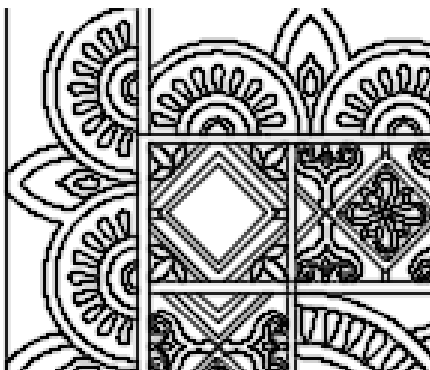

Typical Design Modules

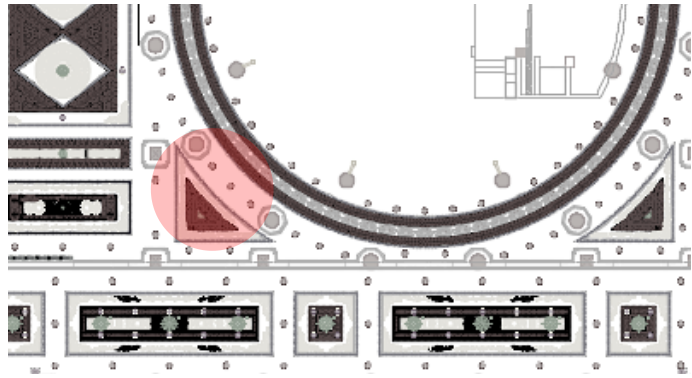

PANEL DESIGN

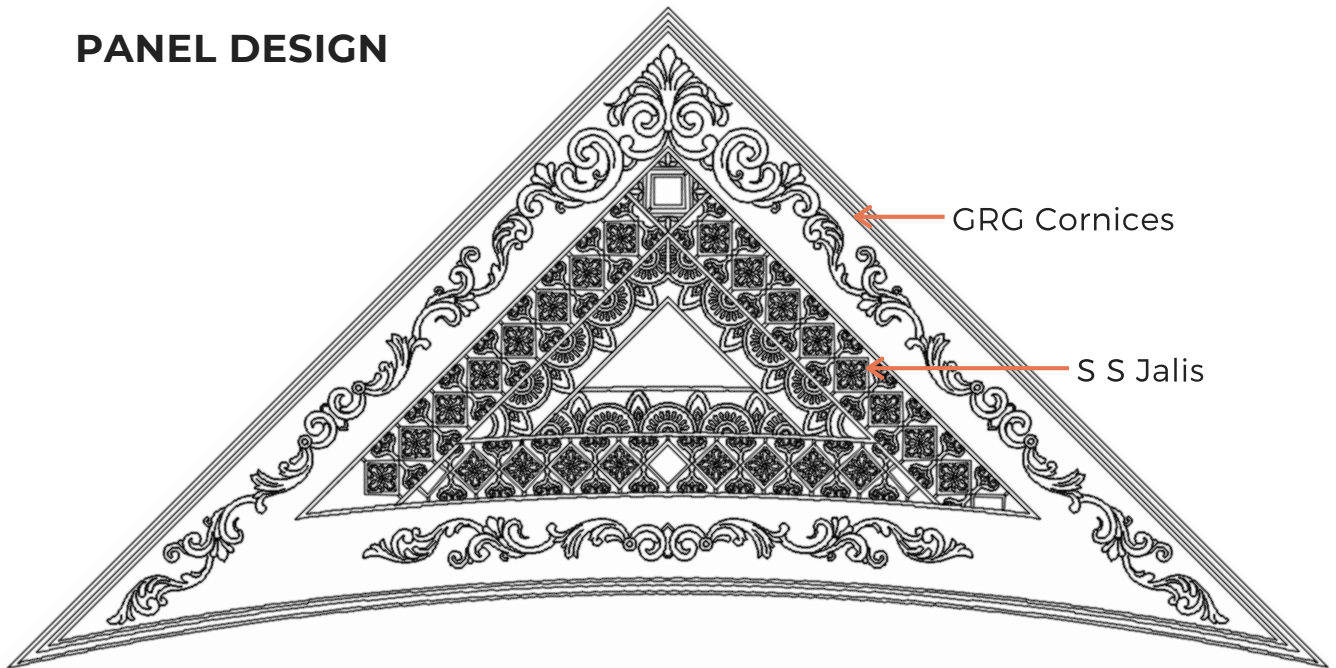

INTRICATIONS

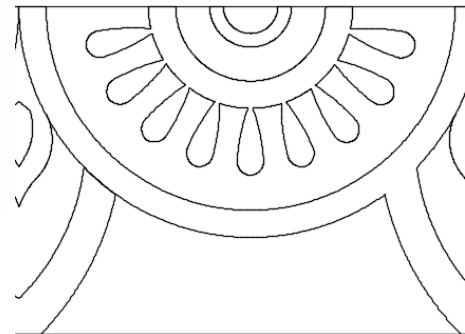
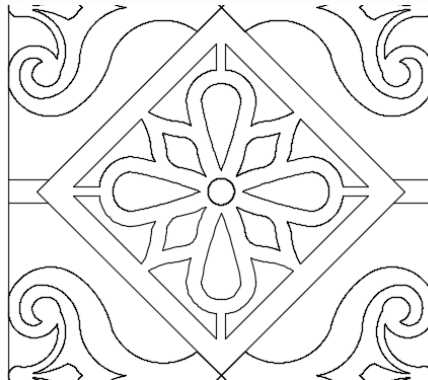
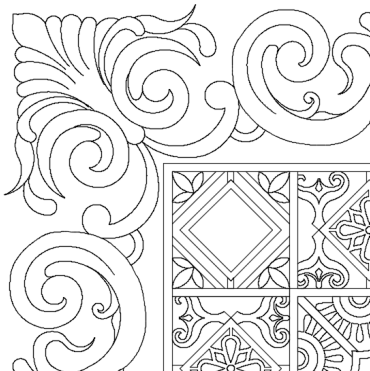

Typical Design Modules

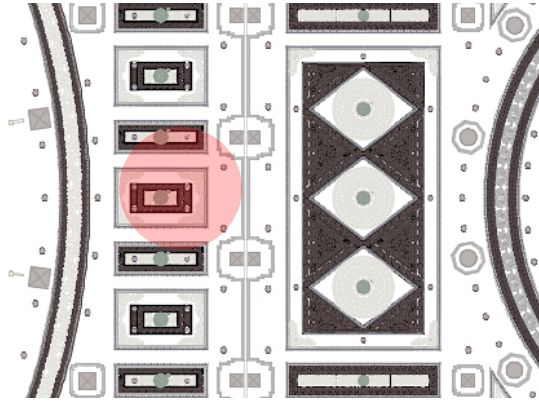

PANEL DESIGN

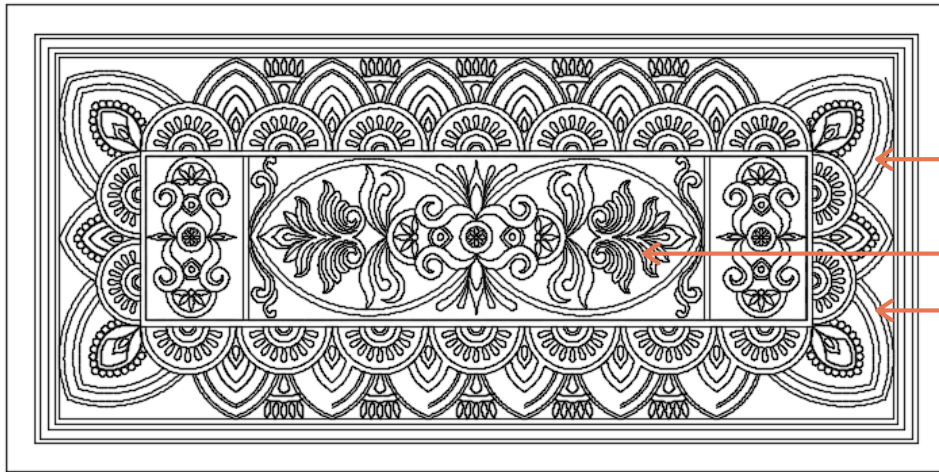

GRG Cornices

GRG Intrications

S S Jalis

INTRICATIONS

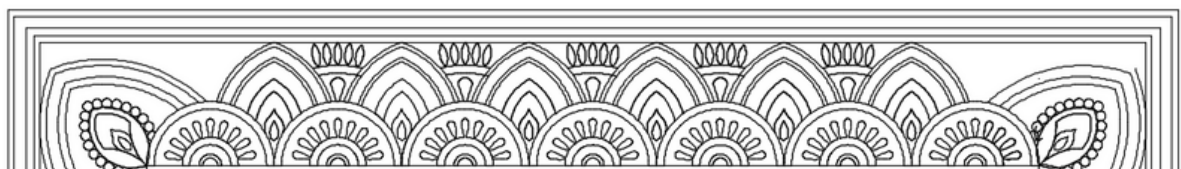
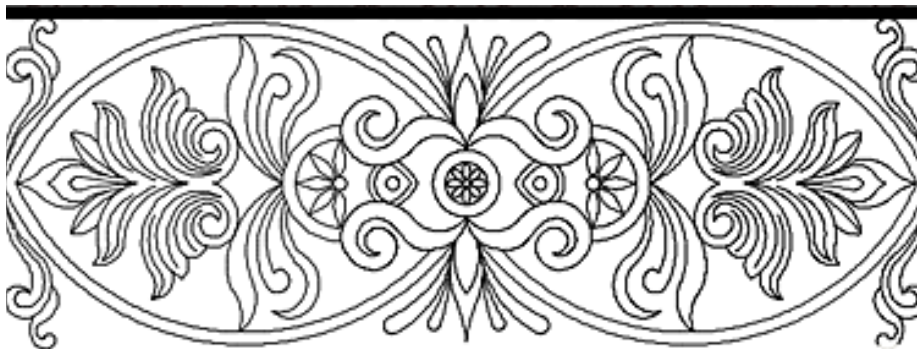

"Coming together is a beginning.
Keeping together is progress.
Working together is success." --
Henry Ford



Varsha Sharma



Anupama Sheth



Sri Radhavallabha Das



Hrishikesh Vaze



Sandarbh Rajput



Anuja Sawarkar



Dipti Bhalerao



Aishwarya Jadhav

The Faces
Behind
Design
Details.

God is in the Details

Each Module in the Reflected Ceiling Plan is designed taking in consideration the structural works laid on the temple floor. Thus the design varies in size, shape and pattern yet keeps the integrity in place.

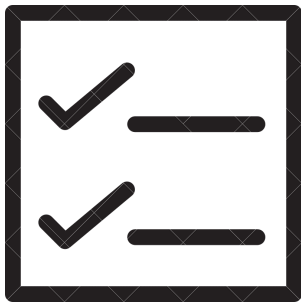

It provides exhibiting the structure as a complete than as individual drawings.

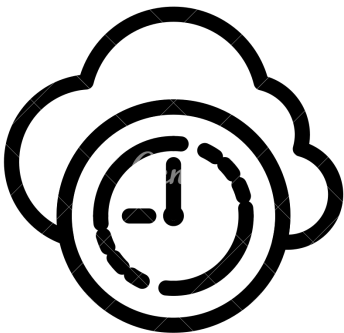

The most significant benefit of using MEP Shop Drawings is that it reduces the time for engineers and contractors. Hence, it updates the final results.

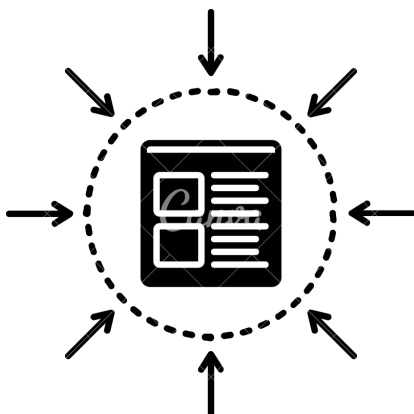

MEP shop drawings also give an enhanced level of specification for fabrication and installation. HVAC, i.e., Heating, ventilation, & air conditioning or any mechanical elements which may need for prefabrication includes duct-work, air-handling units etc.