



NOVEMBER 2021

PAINTING A VISION

TOVP ARCHITECTURE DEPARTMENT, PUNE

A WORD FROM THE HEAD ARCHITECTS

The regal vision that Srila Prabhupada laid out on us for the Temple of Vedic Planetarium is on its way to completion. We recently celebrated his 125th birth anniversary by welcoming him into the Temple with multiple celebrations.

Design is a step wise process which when done systematically leads to a unique outcome. The design team of the ToVP has been working meticulously for the past years to make the final output of the Temple, a home for all.

As designers we go through multiple levels of designs, development , drawings, coordination, to sync our design ideologies to fit with technical aspects such as electrical, plumbing, ventilation and many such services.

Various people all across the globe have contributed in their own ways to the community and Srila Prabhupada's vision. As designers we have tried to contribute the best of our learnings into conceptualisation and execution. Listed in the following pages are a few of our upcoming and ongoing works.



VARSHA SHARMA

VILASINI DD



A CONTRIBUTION TO THE VISION LAID OUT DACADES AGO

The ToVP was a vision laid out by Srila Parbhupada, following which a series of events later, in 2009, the first pile of was sunk. Over the years people from various professions and interest have been working on the ToVP.

The design team, based in Pune has been the core of the amalgamated professions of structural engineers, electrical consultants, artists and more. As the vision is gradually coming live and the opening ceremony just around the corner, here are a few updates on the latest work of the ToVP.



"Every great design begins with an even better story."

The ToVP writes a story, a story with detailed narratives that walk through the user journey, step by step but annotated with context, motivation and expectation. This extra step in design helped us to more quickly and effectively to create truly unique and delightful user experiences.

DRAWINGS ON THE TABLE



01

TERRACE PARAPET
COLUMN

02

GRANDSTAIRCASE
FLOORING

03

MAIN DOME AND SIDE
DOME WINDOWS

04

MAIN ALTAR
SHRINGASAN

05

SP VYASASANA

06

UTILITY BLOCK

Designed with a beautiful balance of colours and materials like marbles and gold, the Vyasasana aims to be one of the major highlights of the Temple floor. Post design finalisation, the working drawings are now in progress.

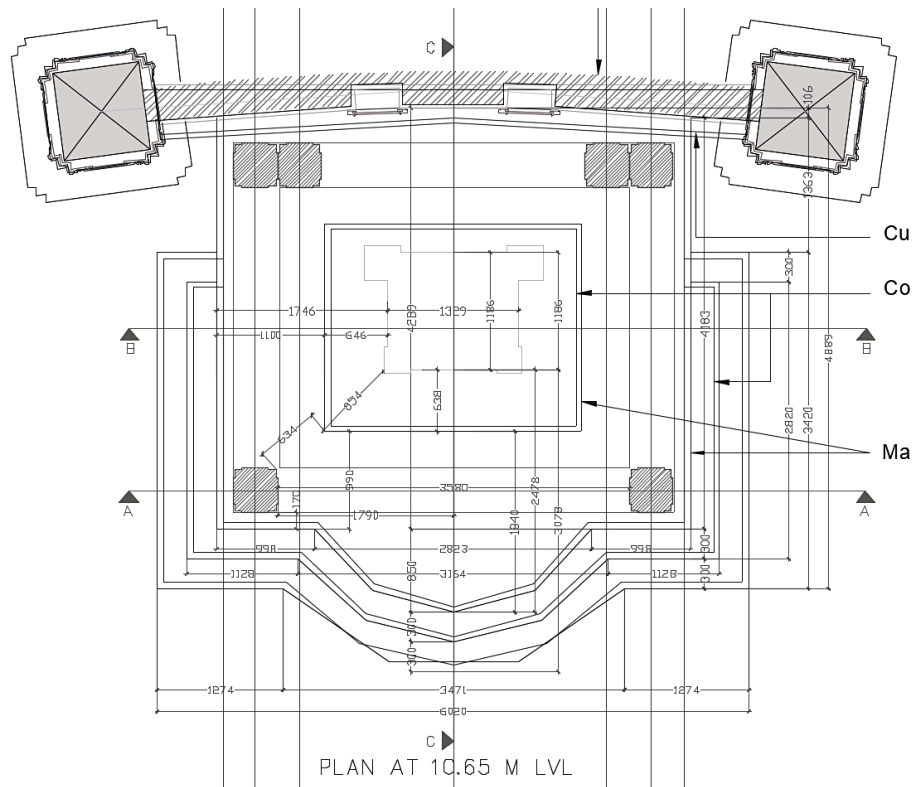

DETAILED DRAWINGS

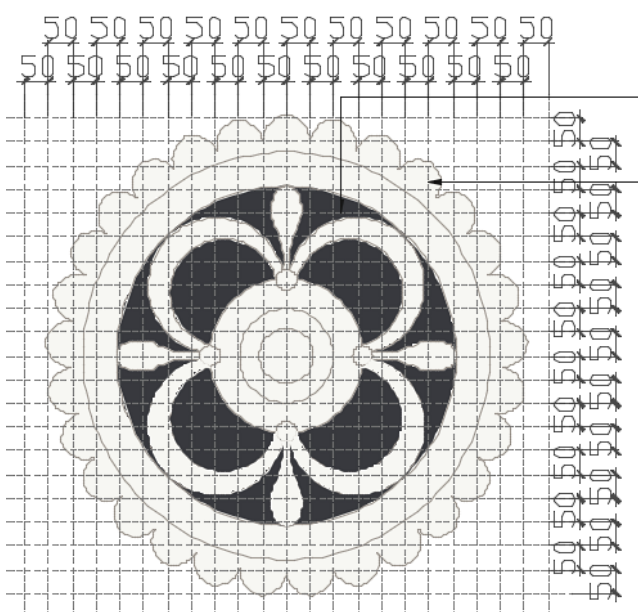

motif details

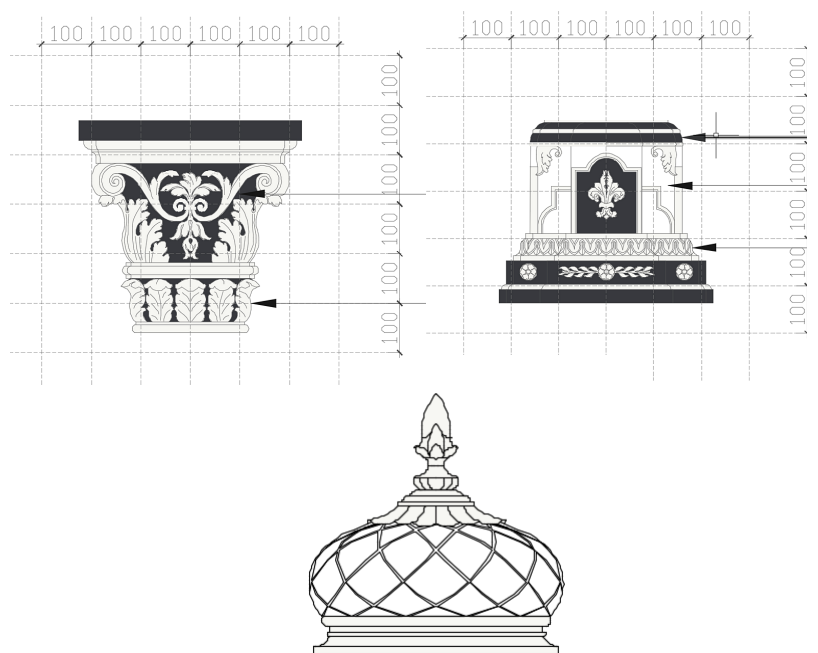

column and side dome
details

Terrace Parapet Columns

A melange of sandstone carvings combined to form the terrace columns, this design is the perfect barrier on terraces whilst balancing a visual connection. Alterations are being made currently to suit the change in column size as per site requirements.

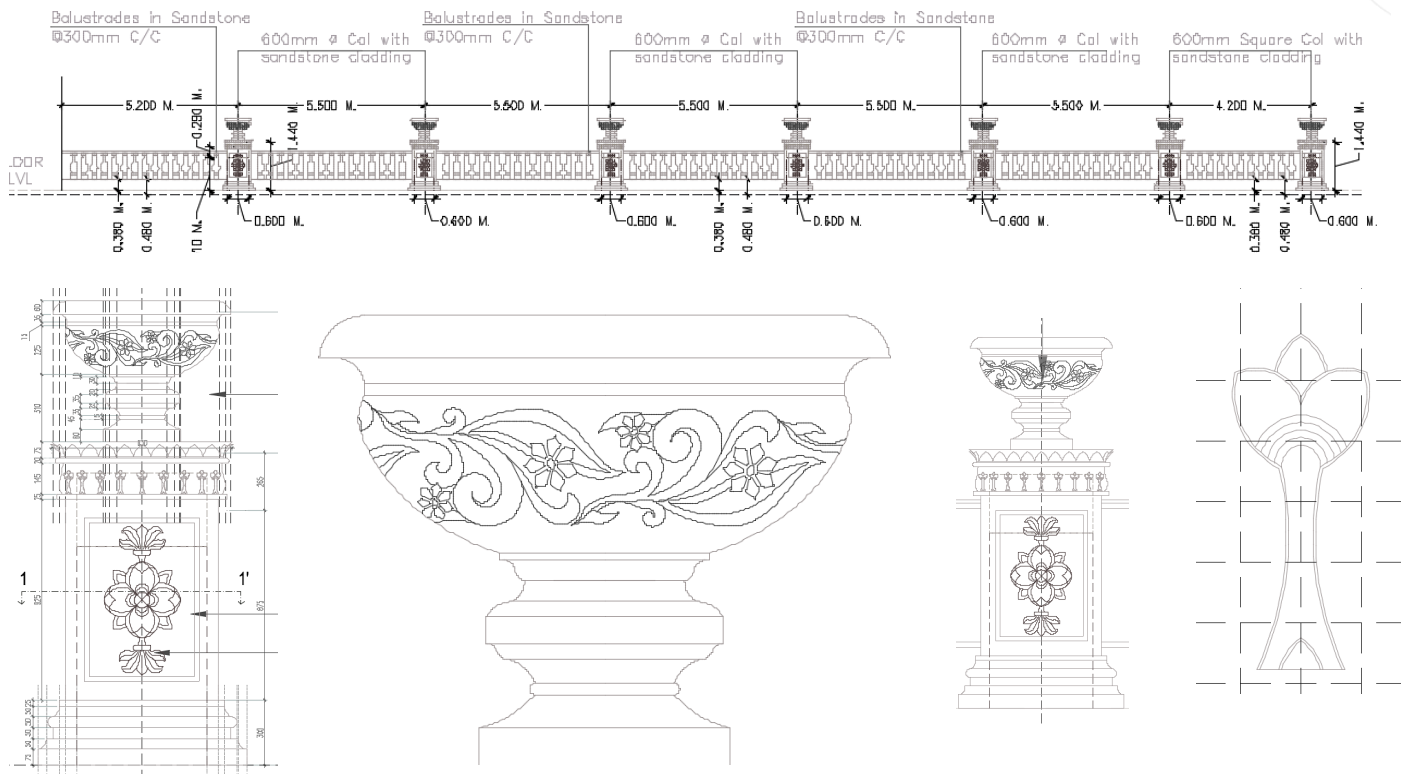

PROGRESS ON SITE



Grand Staircase Flooring

For added comfort of the pilgrims, the tread sizes are proposed to increase. Post that, the team is now in the process of designing flooring for the same. We have gathered inspiration from various sources and are now optimising them to suit best for the overall design. For the flooring design, we have done various studies and analogies and are now working on finer design details.

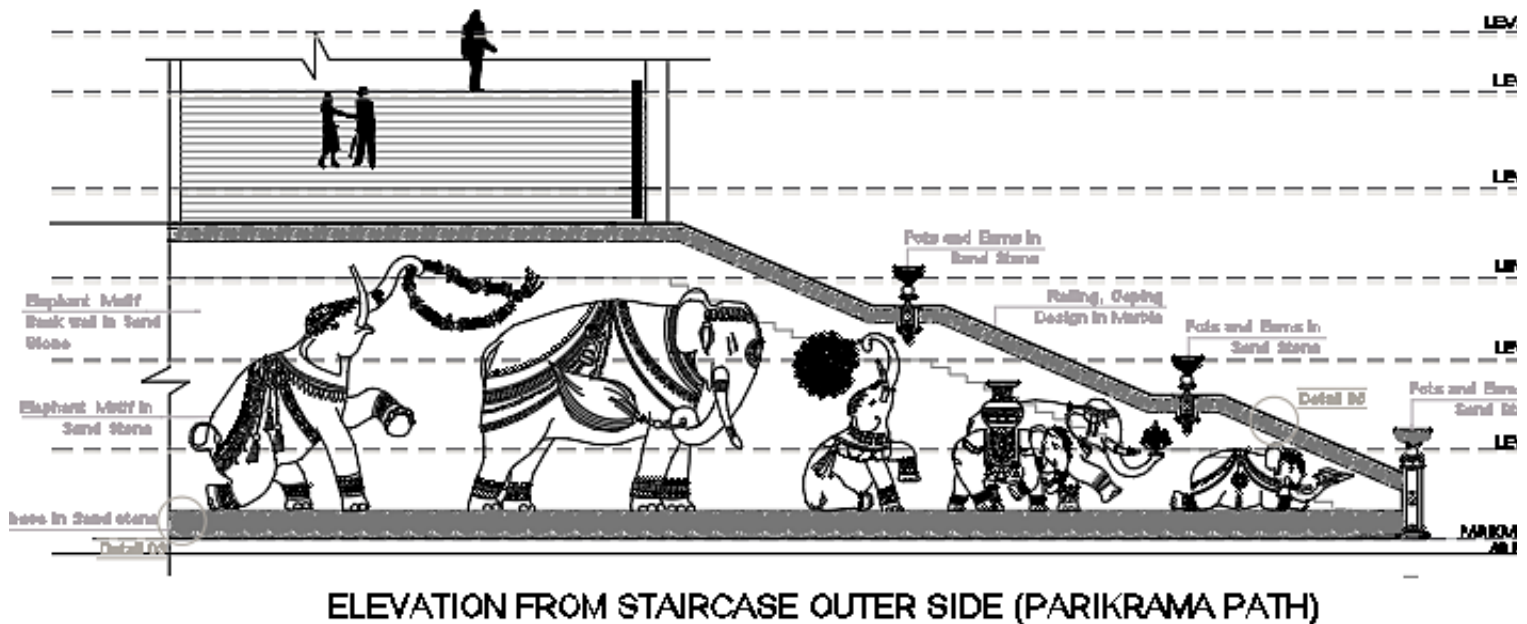

DETAILED DRAWINGS



Grand Staircase Flooring

PRESIDENT STUDIES AND ANALOGIES

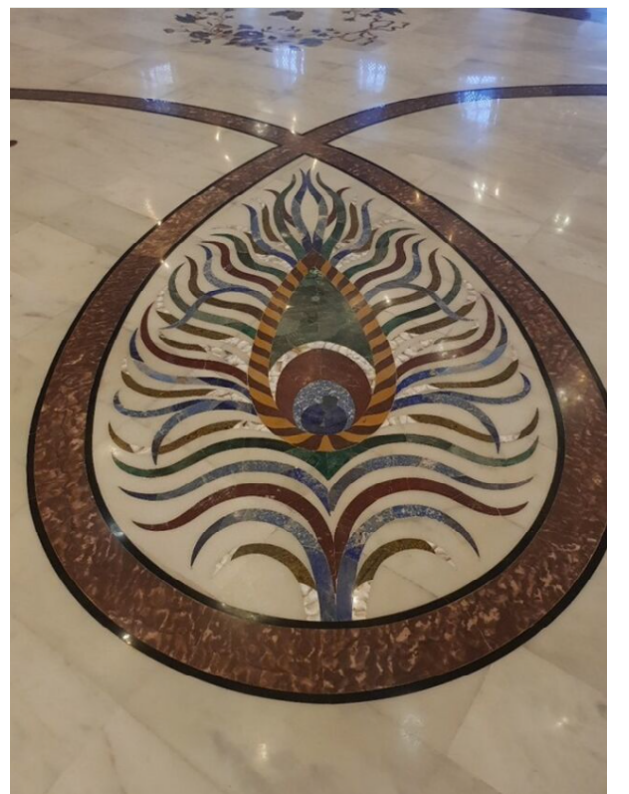

Tier Doors and Windows

The major change in design for the window came with the change in drawing from the frame dimensions. It is now in its way of completion.

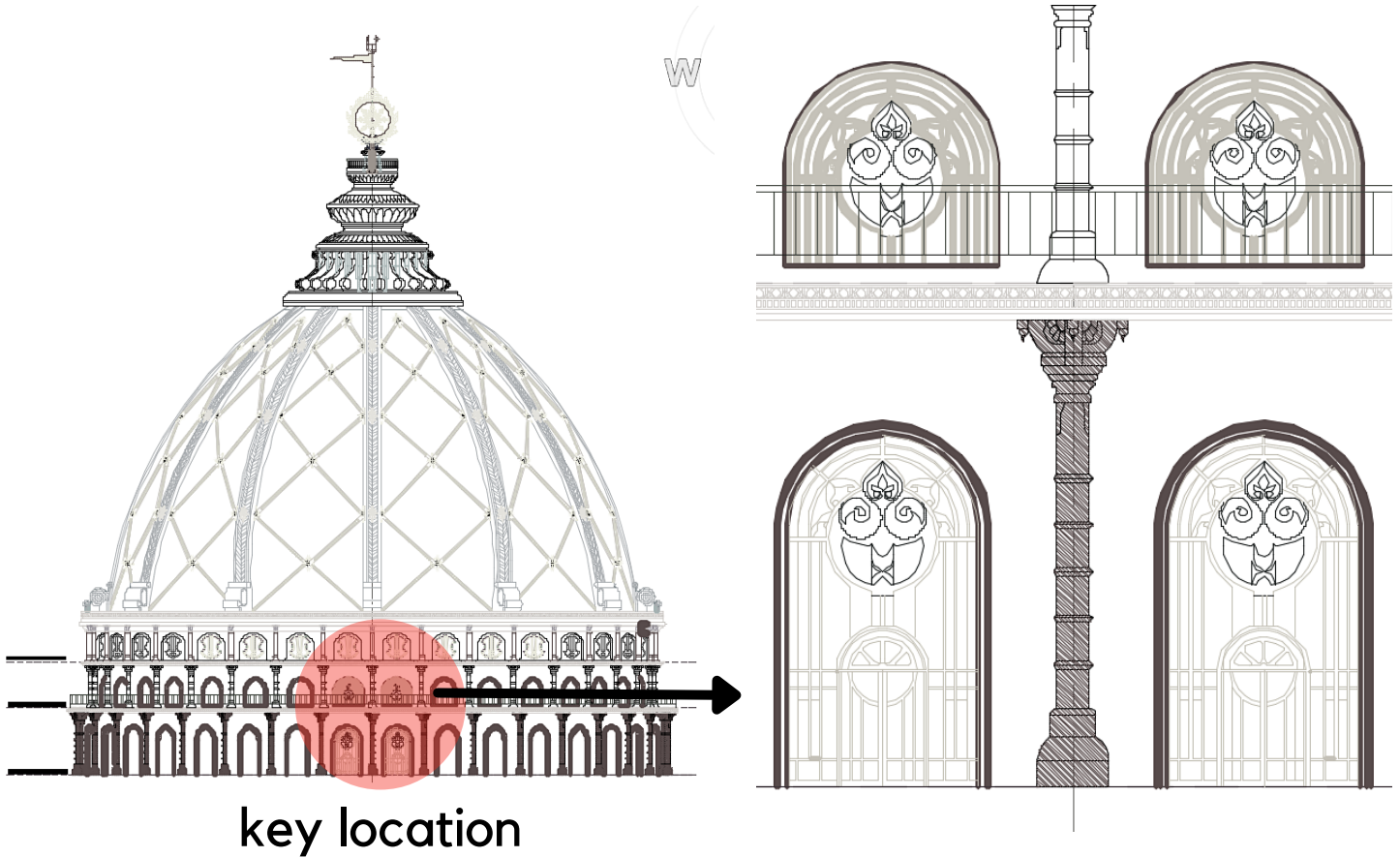

SITE IMAGES

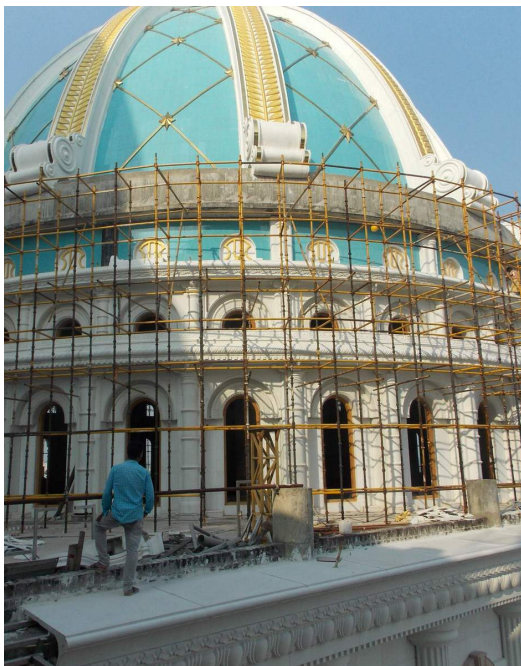

Main Dome Tier

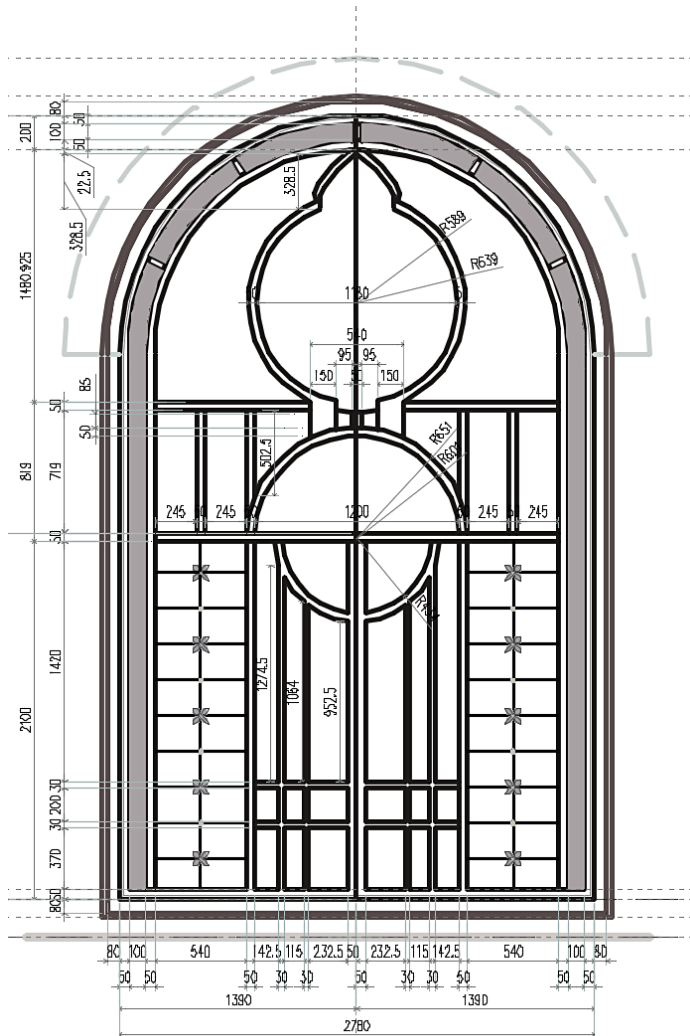

door elevation

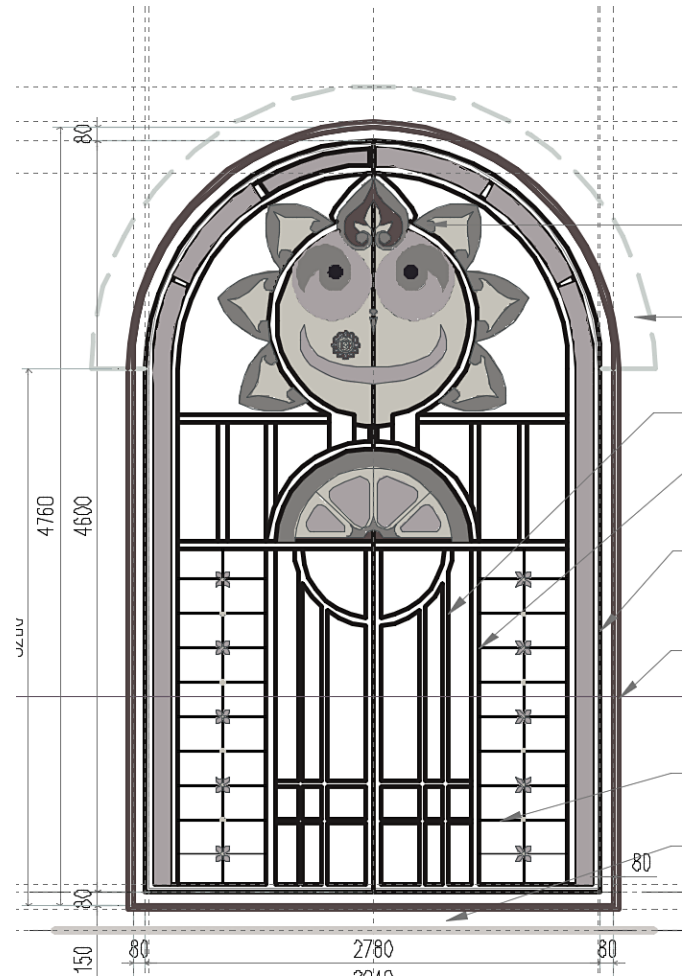

door elevation

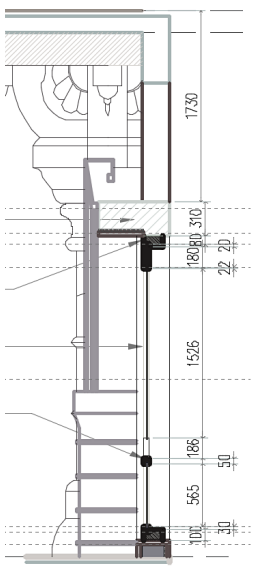

section

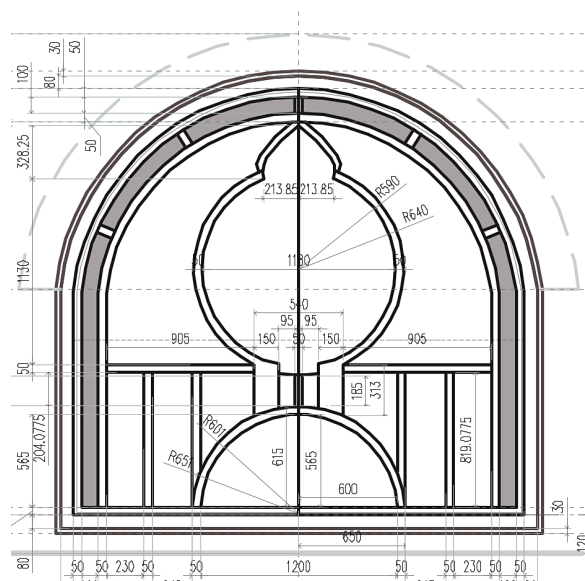

window elevation

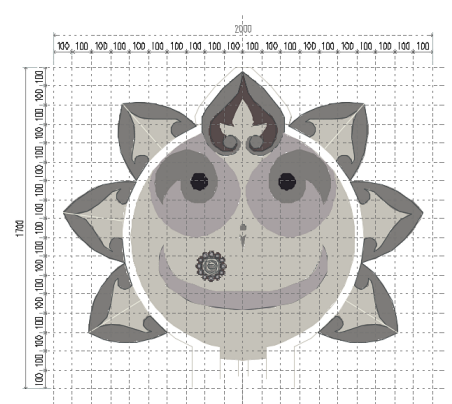

measure drawing

Side Dome Tier

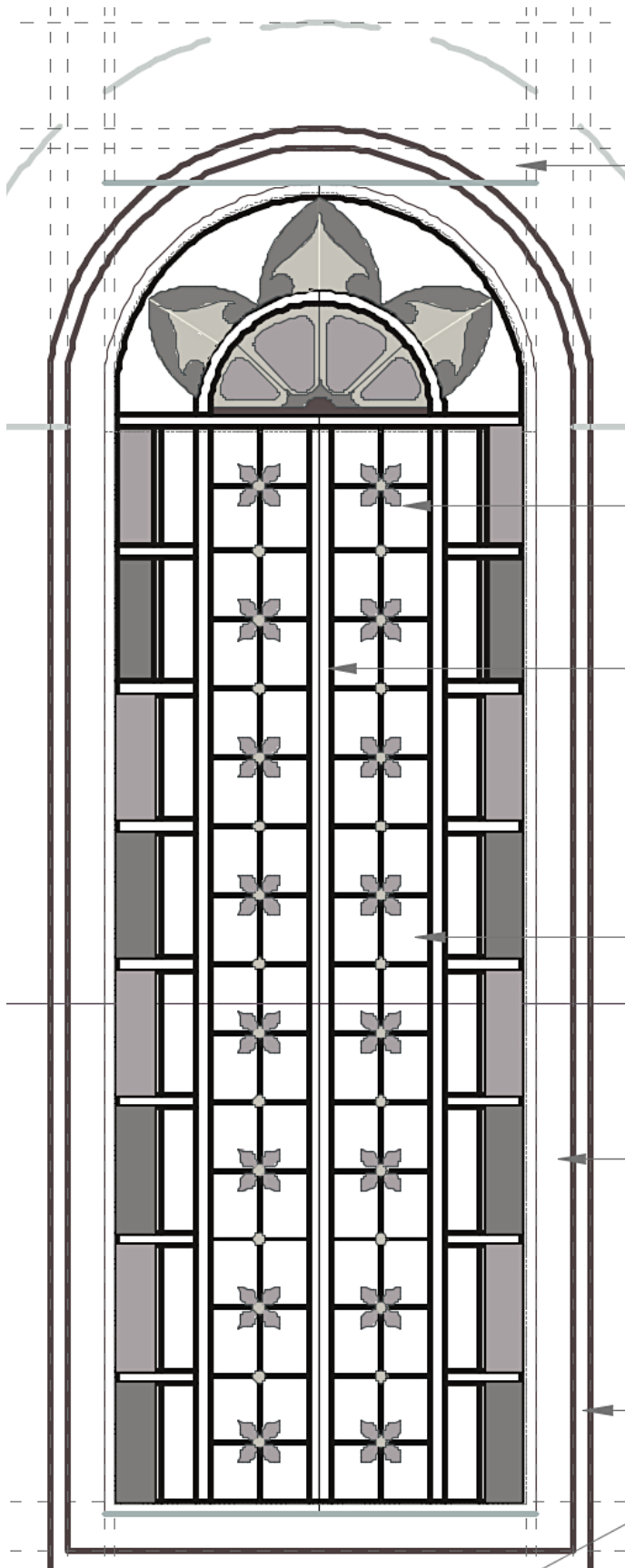

door

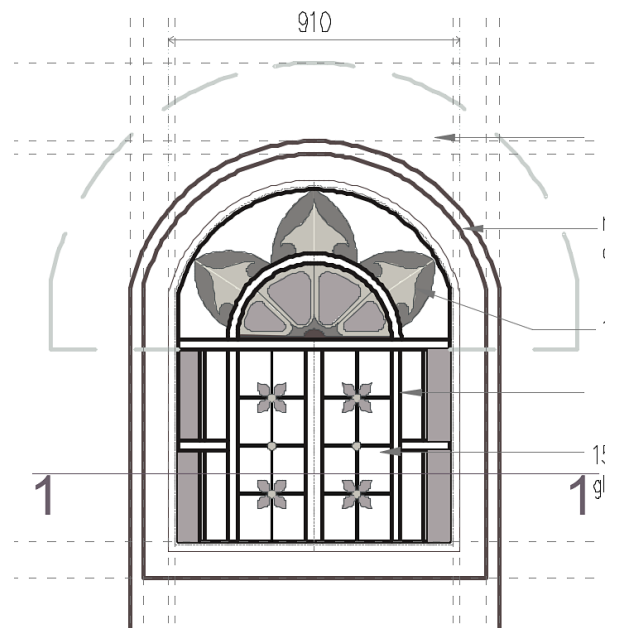

window

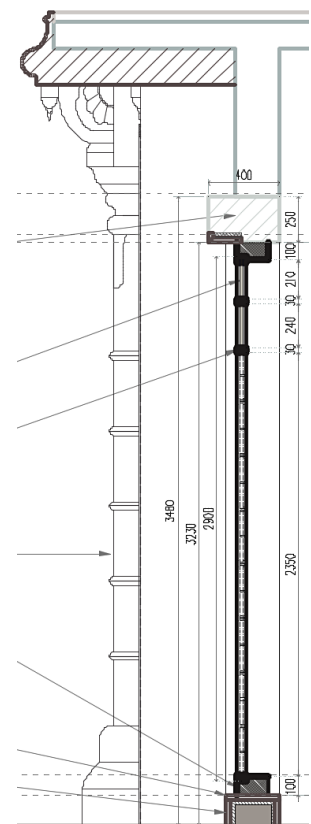

section

Main Altar Sringasana

Designed with a beautiful balance of colours and materials like marbles and gold, the Vyasasana aims to be one of the major highlights of the Temple floor. Post design finalisation, the working drawings are now in progress.

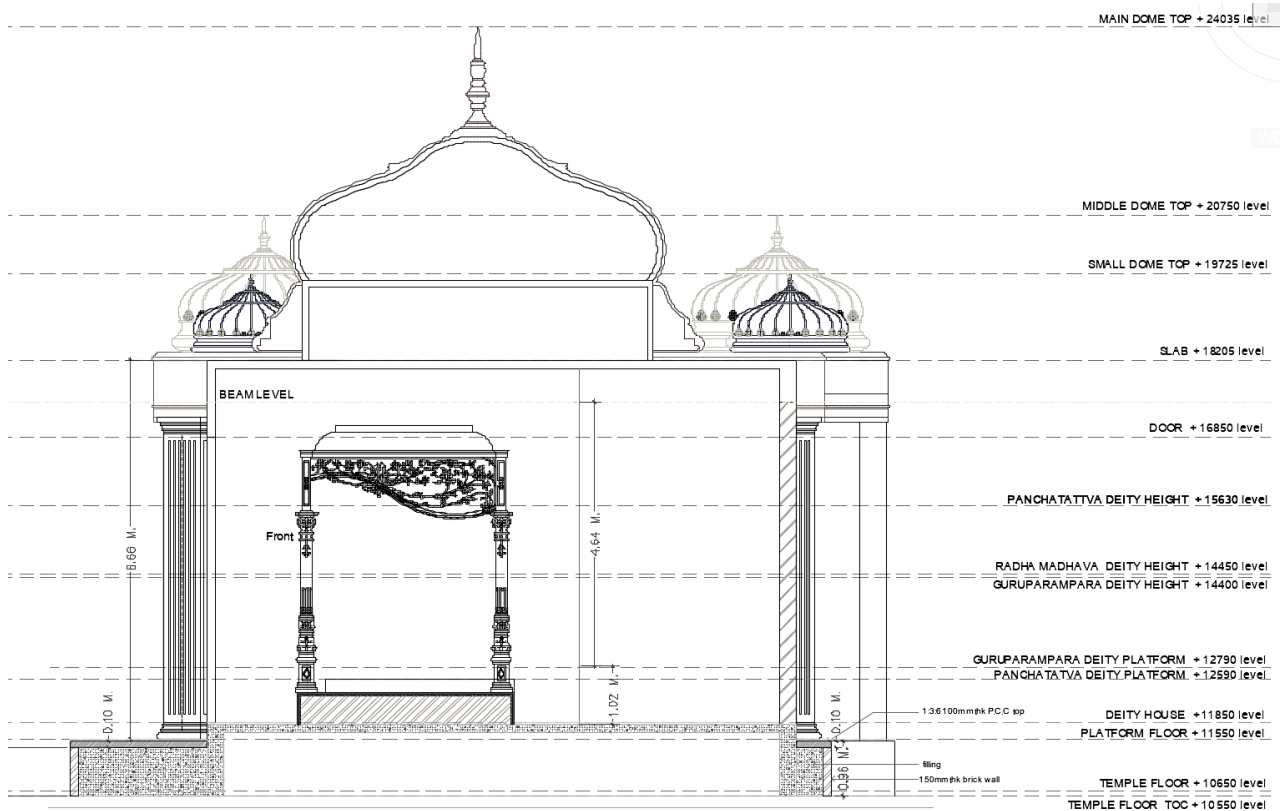

DETAILED DRAWINGS

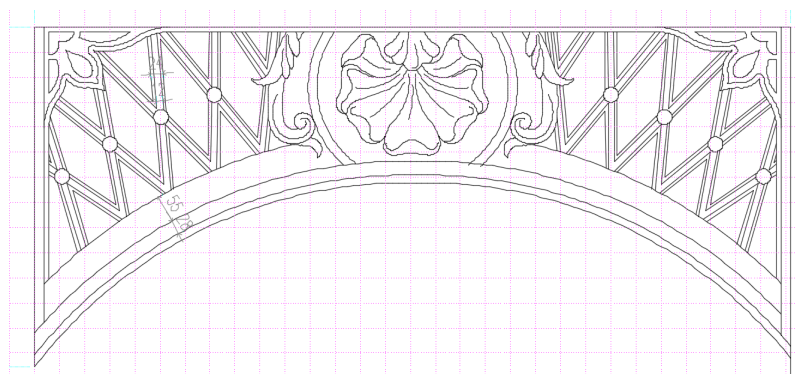
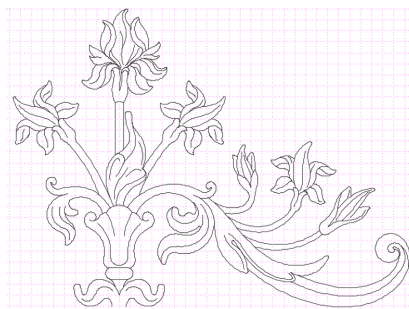
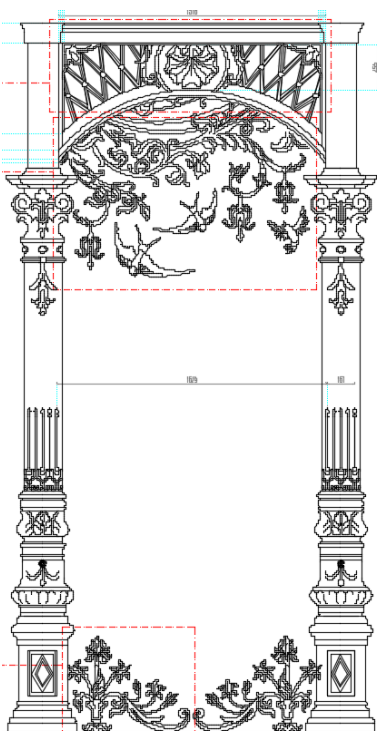

Main Altar Sringasana

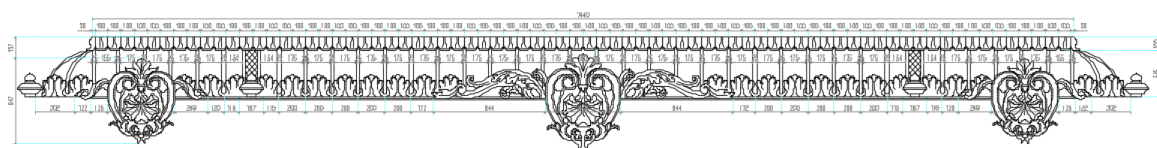

ornamentation details

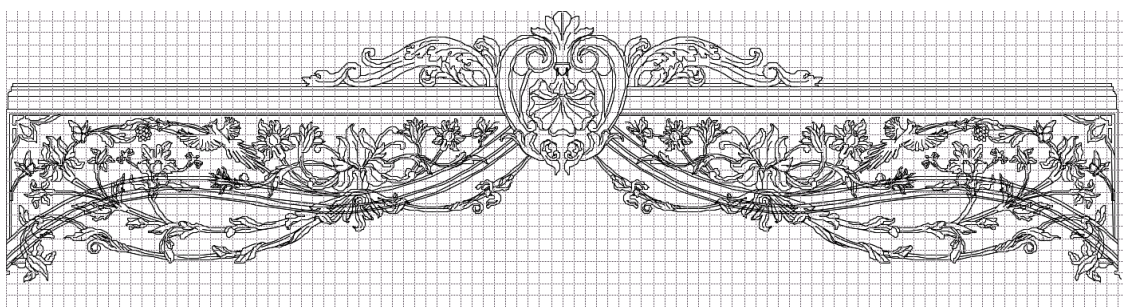

ornamentation details

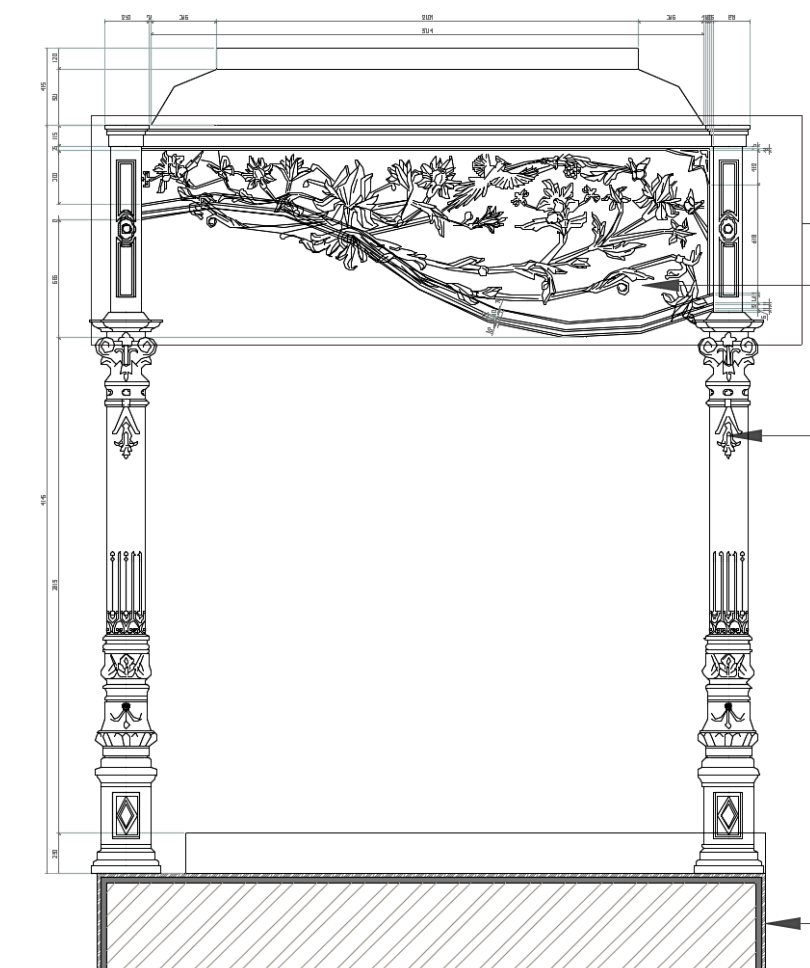

side elevation

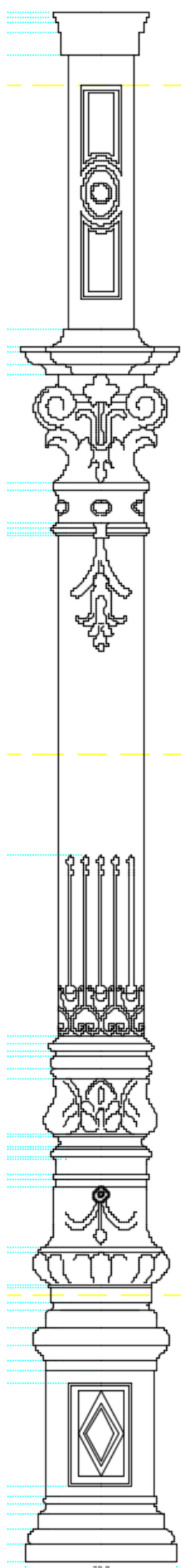

column details

Vyasaasana

WORKING DRAWINGS

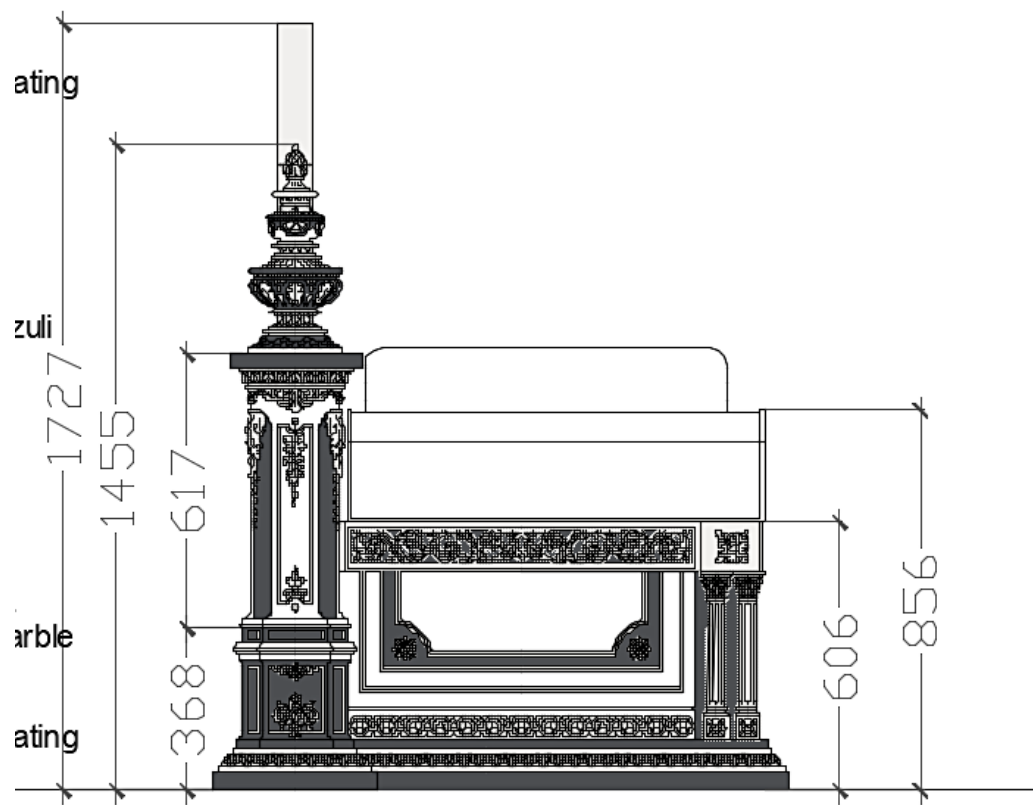

seating details

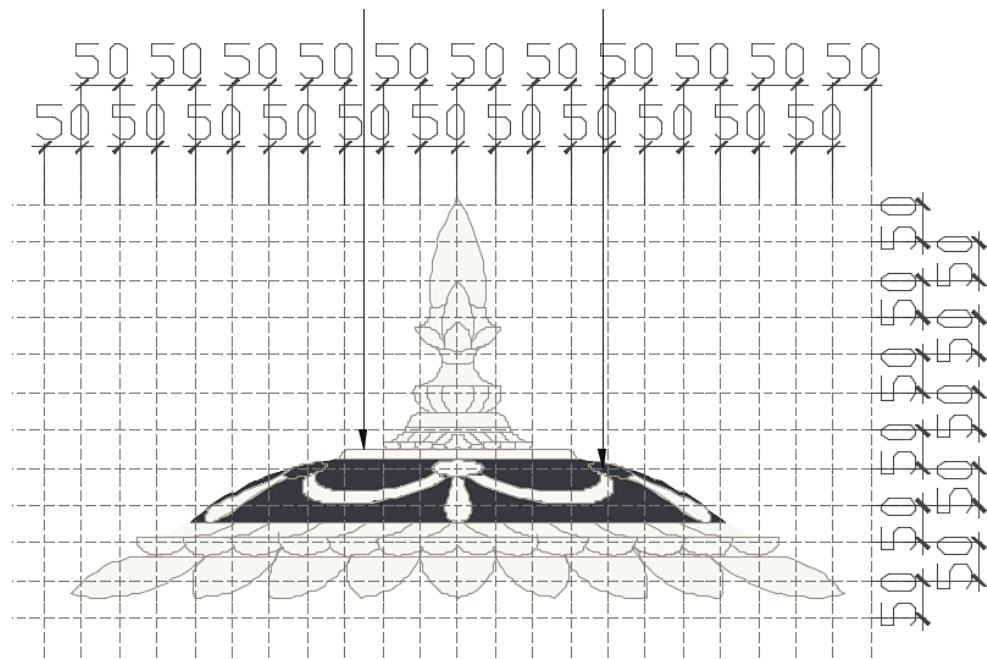

measure drawings

Utility Block Design-Concept

Designed for essential services and requirements, the utility block is a simple crisp and to the point design. We are in process for designing spaces and contemplating the required areas and the planning of the block is ongoing.

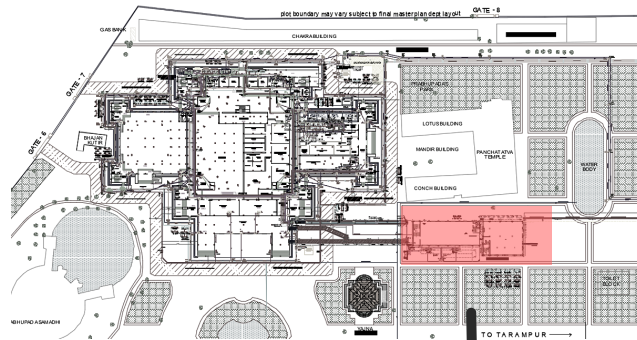

key location

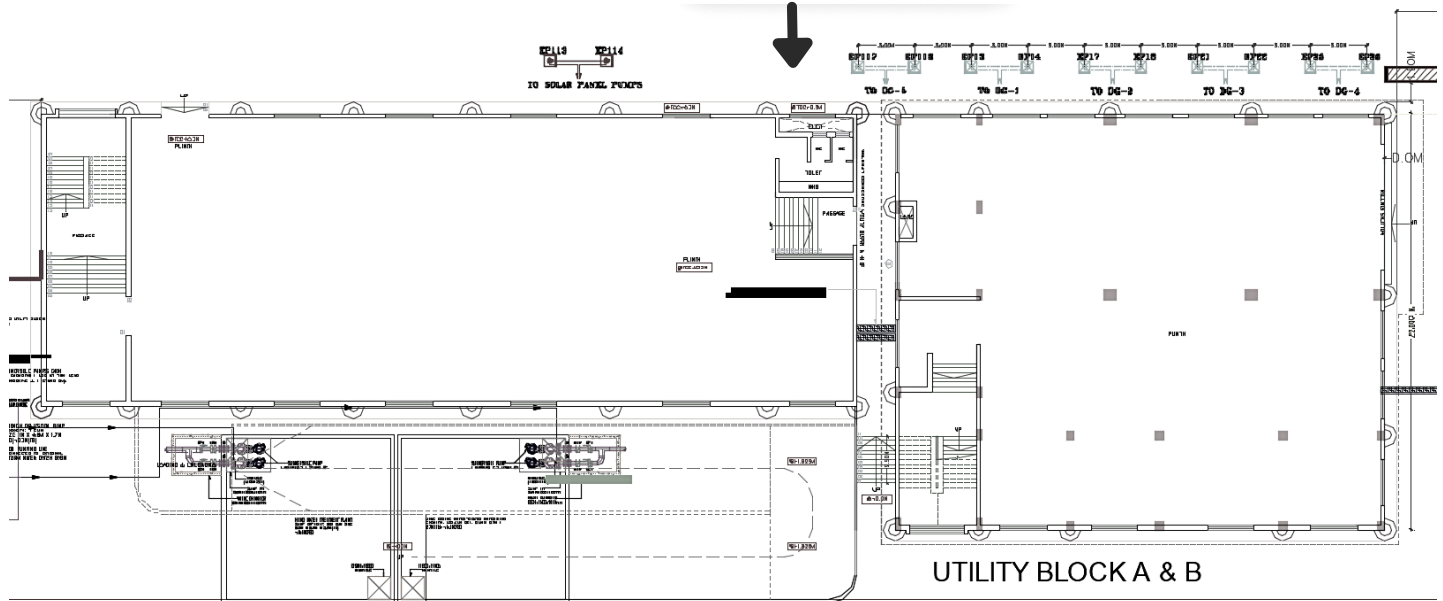

plan

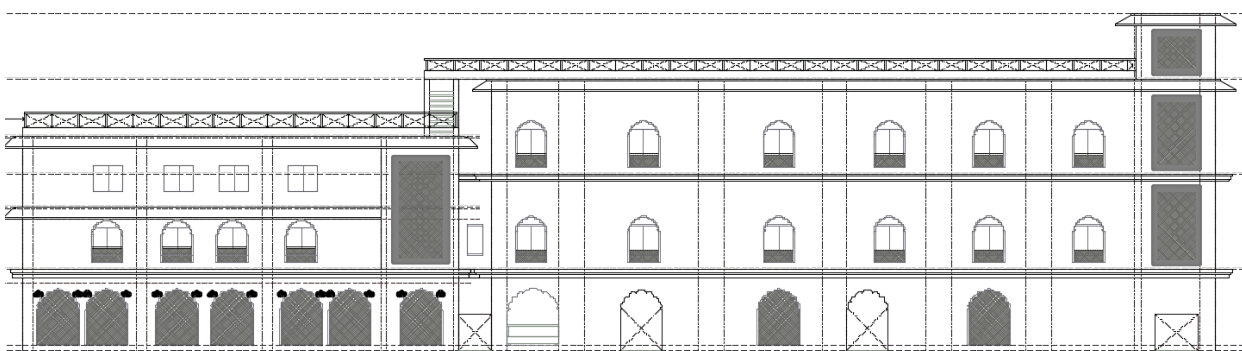

elevation

35%

Drawings Completed

72%

work in progress

CONCLUSION

“Human-centered design is a philosophy, not a precise set of methods, but one that assumes that innovation should start by getting close to users and observing their activities.”

The main tenet of the ToVP's design is empathy for the people you're trying to design for.

Architectural design is the thorough and systematic evaluation of the interrelated values, goals, facts, and needs of a habitat and its community. The ToVP aims at being a shelter and place of comfort for people from all over the world.

Hence the design process is an empathetic yet guided approach to accommodate people from various cultures and nationalities and to make them feel at home under this massive dome.

